

RAY F1

Designed by Rodolfo Dordoni, 2007

F5916030

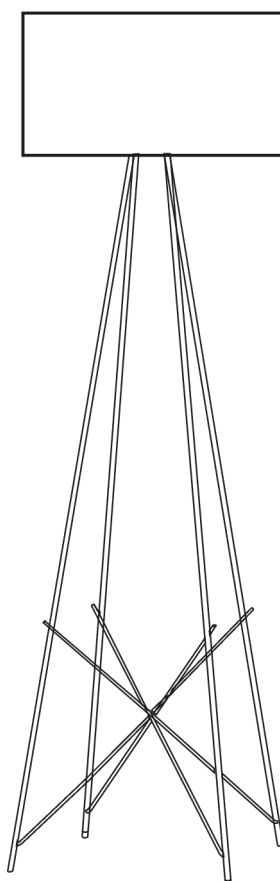

RAY F1

F5916030

EN

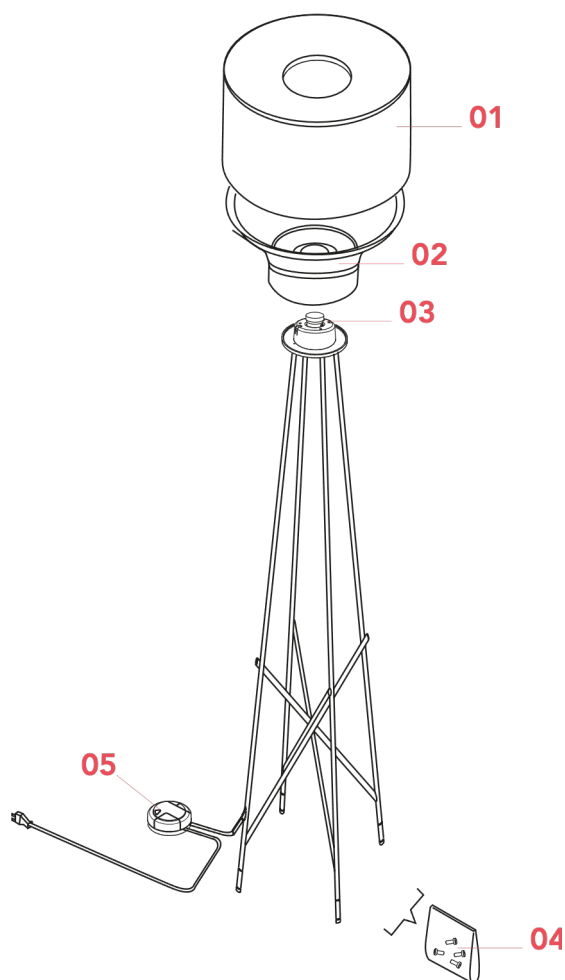

- 01. RF16084 – Polished black aluminium F1-T
- 02. RF15854 – F1-T Diffuser support
- 03. RF04487 – E27 620 Porcelain lamp holder
- 04. RF5912100 – Kit of quantity 4 adjustable feet
- 05. RF28045 – Led 220-240V 40-250W 4-100W Rondò dimmer

RAY F1 F5916030

EN

RF16084

F1-T DIFFUSER

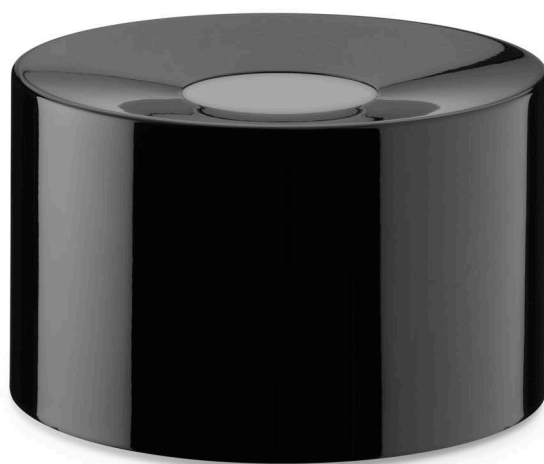

Ray F1
p.03



Ray T
p.03

WARNING! When installing and whenever acting on the appliance, ensure that the power supply has been switched off.
For the installation of the spare-part, it is necessary to consult a qualified electrician.

RAY F1 F5916030

EN

RF16084

F1-T DIFFUSER

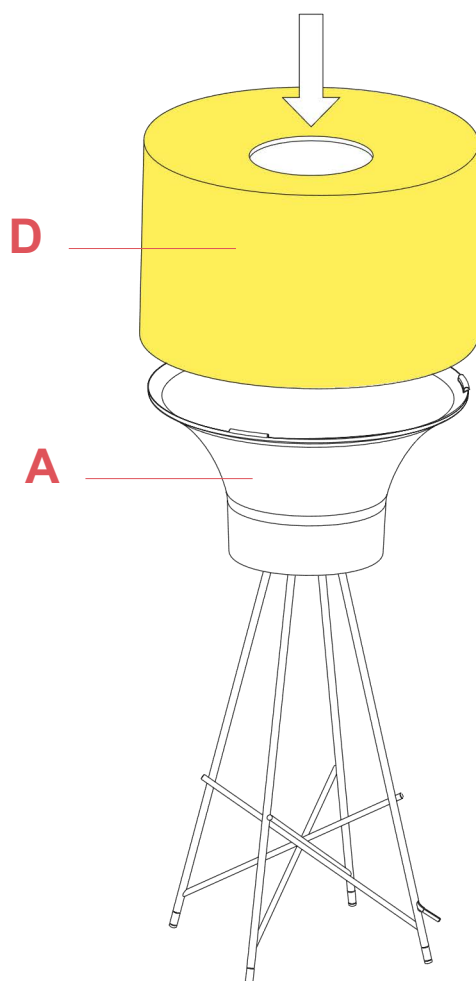

Fig.1

Position the diffuser (D) on the support (A).

WARNING! When installing and whenever acting on the appliance, ensure that the power supply has been switched off.
For the installation of the spare-part, it is necessary to consult a qualified electrician.

©2021 Flos - All rights reserved - www.flos.com
Flos reserves the right to introduce any changes to its own models, without prior notice.

RAY F1 F5916030

EN

RF15854

F1-T DIFFUSER SUPPORT



Ray F1
p.05



Ray T
p.05

WARNING! When installing and whenever acting on the appliance, ensure that the power supply has been switched off.
For the installation of the spare-part, it is necessary to consult a qualified electrician.

RAY F1 F5916030

EN

RF15854

F1-T DIFFUSER SUPPORT

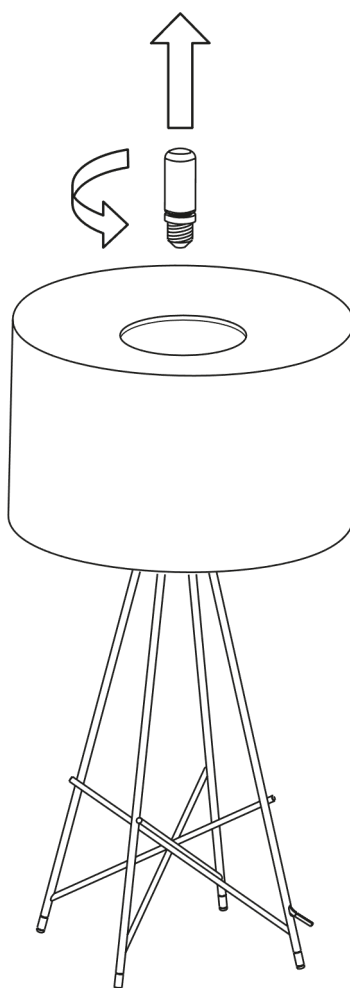

Fig.1

Verify that the lamp-bulb has been removed from the device.

WARNING! When installing and whenever acting on the appliance, ensure that the power supply has been switched off.
For the installation of the spare-part, it is necessary to consult a qualified electrician.

©2021 Flos - All rights reserved - www.flos.com
Flos reserves the right to introduce any changes to its own models, without prior notice.

RAY F1 F5916030

EN

RF15854

F1-T DIFFUSER SUPPORT

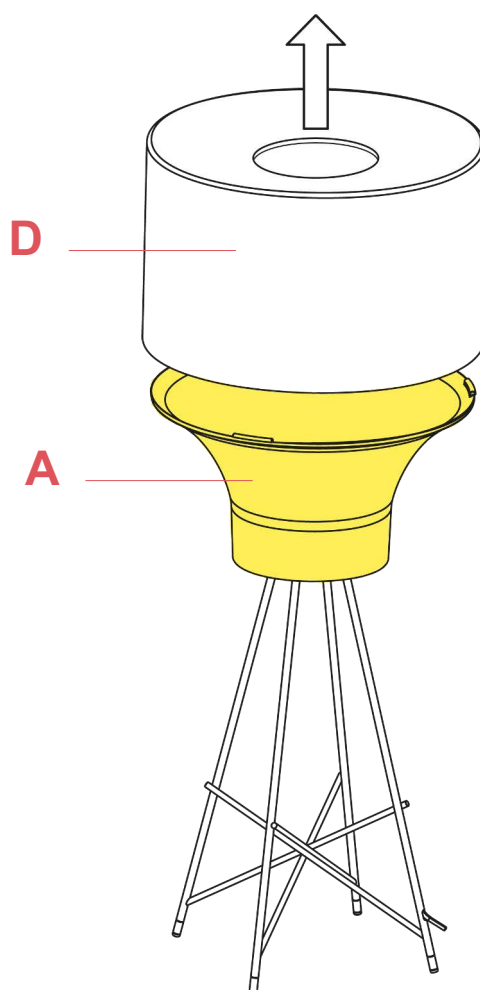

Fig.2

Remove the diffuser (D) from its support (A).

WARNING! When installing and whenever acting on the appliance, ensure that the power supply has been switched off.
For the installation of the spare-part, it is necessary to consult a qualified electrician.

RAY F1 F5916030

EN

RF15854

F1-T DIFFUSER SUPPORT

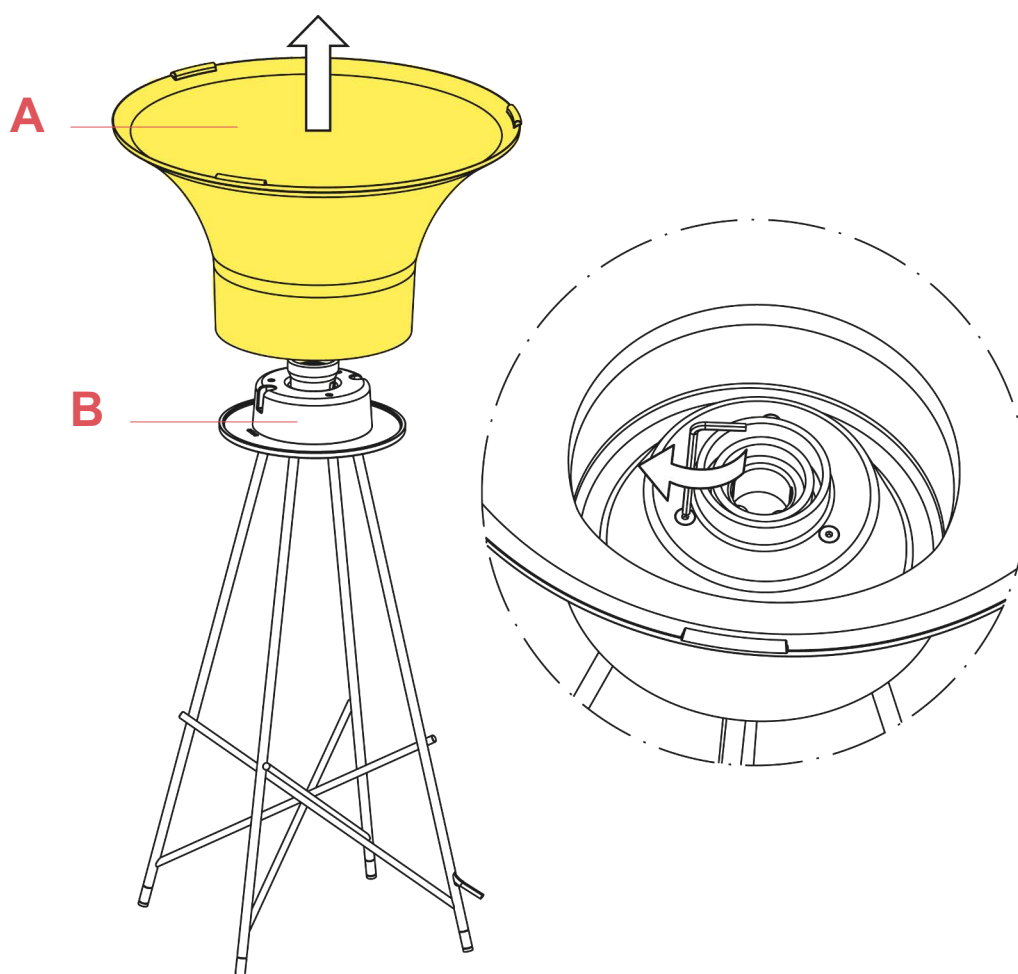

Fig.3

Unfasten the three screws (C) inside the diffuser support (A), by utilizing an Allen key and then remove the diffuser support (A) from the unit (B).

Assemble now the new spare-part:

Assemble the diffuser support (A) on the unit (B) by fastening the screws (C).

Collocate the diffuser (D) on the diffuser support (A).(Fig.2 page 7)

Insert the lamp-bulb.(Fig.1 page 6)

WARNING! When installing and whenever acting on the appliance, ensure that the power supply has been switched off. For the installation of the spare-part, it is necessary to consult a qualified electrician.

RAY F1 F5916030

EN

RF04487

PORCELAIN E27 LAMP HOLDER



Nebula
p.03



Ray F1
p.09



Ray F2
p.09



Ray T
p.09



Tatou
S2
p.16

WARNING! When installing and whenever acting on the appliance, ensure that the power supply has been switched off.
For the installation of the spare-part, it is necessary to consult a qualified electrician.

RAY F1 F5916030

EN

RF04487

PORCELAIN E27 LAMP HOLDER

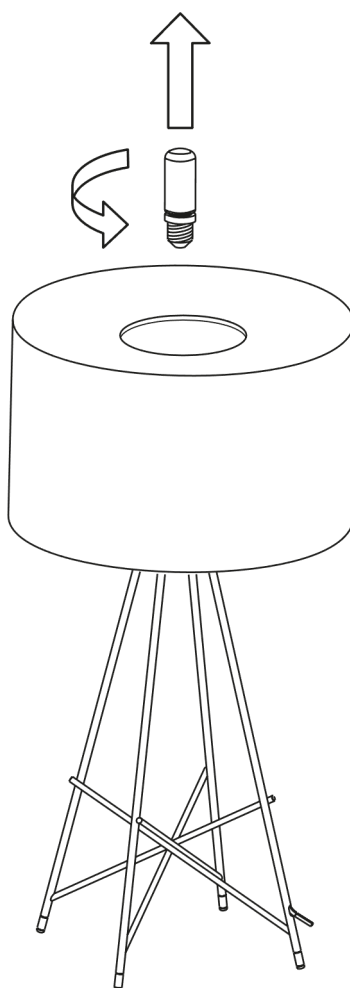

Fig.1

Verify that the lamp-bulb has been removed from the device.

WARNING! When installing and whenever acting on the appliance, ensure that the power supply has been switched off.
For the installation of the spare-part, it is necessary to consult a qualified electrician.

©2021 Flos - All rights reserved - www.flos.com
Flos reserves the right to introduce any changes to its own models, without prior notice.

RAY F1 F5916030

EN

RF04487

PORCELAIN E27 LAMP HOLDER

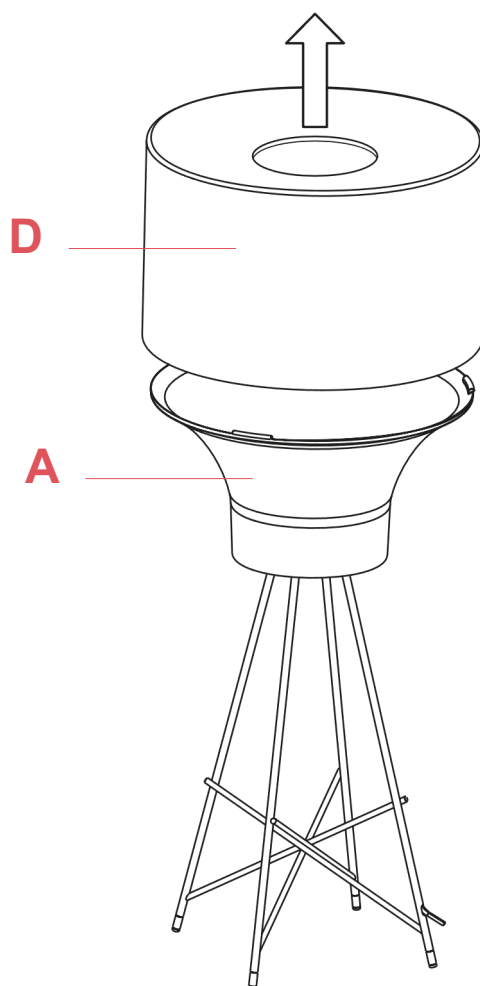

Fig.2

Remove the diffuser (D) from its support (A).

WARNING! When installing and whenever acting on the appliance, ensure that the power supply has been switched off.
For the installation of the spare-part, it is necessary to consult a qualified electrician.

RAY F1 F5916030

EN

RF04487

PORCELAIN E27 LAMP HOLDER

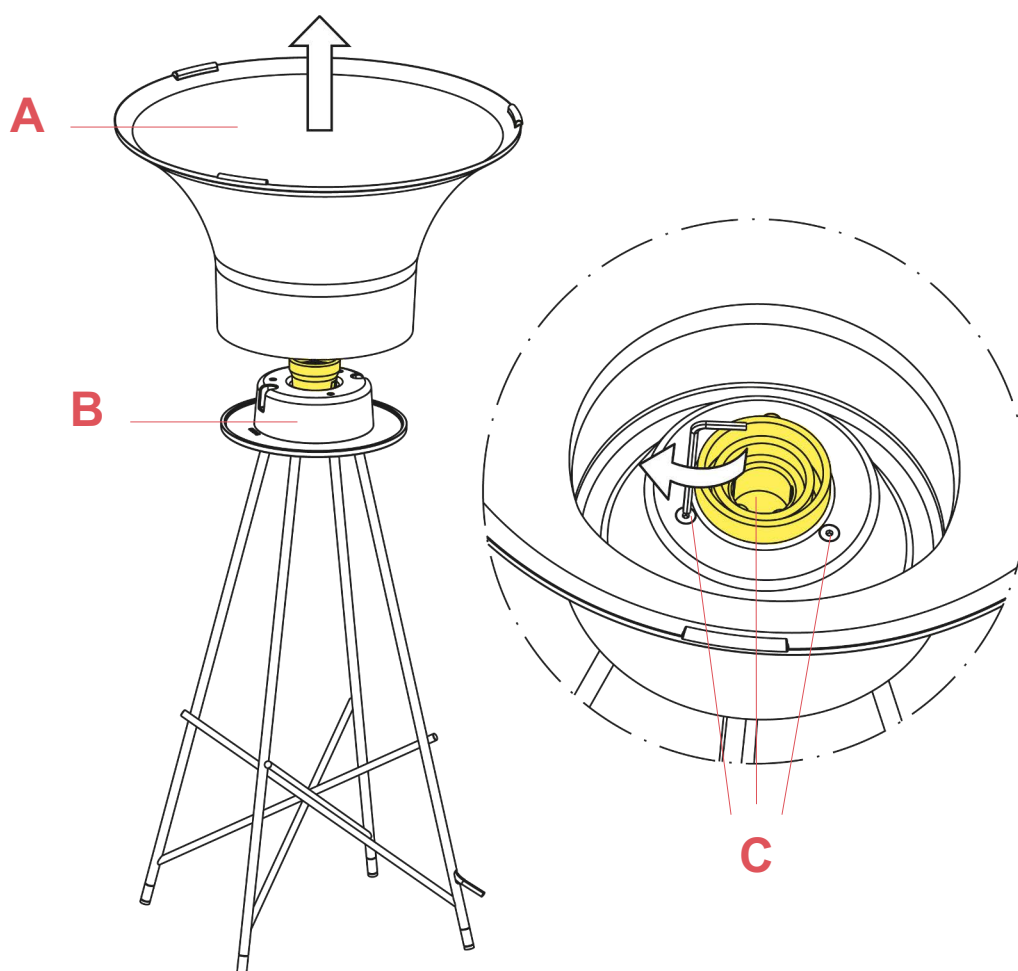

Fig.3

Unfasten the three screws (C) inside the diffuser support (A), by utilizing an Allen key and then remove the diffuser support (A) from the unit (B).

WARNING! When installing and whenever acting on the appliance, ensure that the power supply has been switched off. For the installation of the spare-part, it is necessary to consult a qualified electrician.

RAY F1 F5916030

EN

RF04487

PORCELAIN E27 LAMPHOLDER



Fig.4

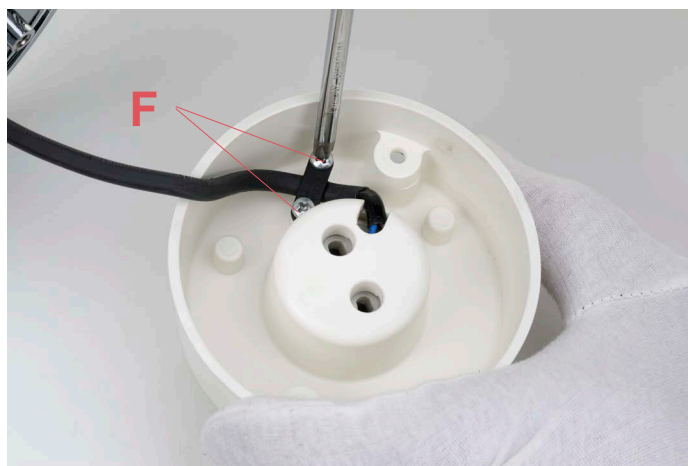

Fig.5



Fig.6

Unfasten the two lateral screws (E) of the lamp holder protection cover.

Lift up the lamp holder protection cover and unfasten the screws (F) of the cable clamp.

Unfasten the lamp holder fixing screws (G).

WARNING! When installing and whenever acting on the appliance, ensure that the power supply has been switched off.
For the installation of the spare-part, it is necessary to consult a qualified electrician.

©2021 Flos - All rights reserved - www.flos.com
Flos reserves the right to introduce any changes to its own models, without prior notice.

RAY F1 F5916030

EN

RF04487

PORCELAIN E27 LAMP HOLDER

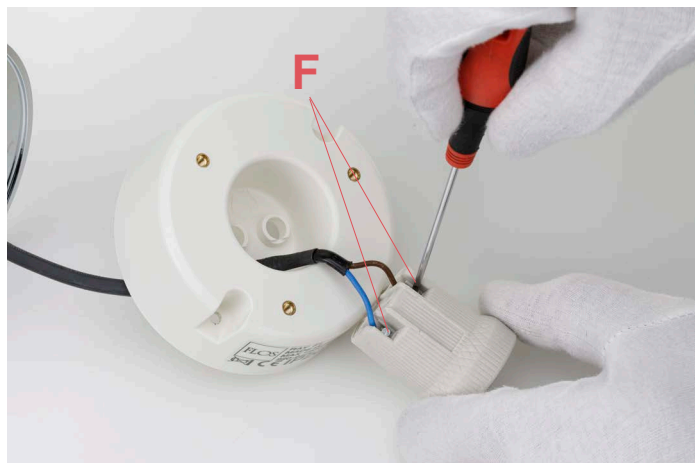

Fig.7

Disconnect the electrical wires (H) from the lamp holder terminals (I).

Assemble now the new spare-part:

Connect the electrical wires (H) of the lamp holder by respecting the polarities (I) indicated in correspondence of the connection terminal.

Connect the Brown (live) wire in the terminal indicated with "L" and then connect the Blue (neutral) wire in the other terminal indicated with "N".

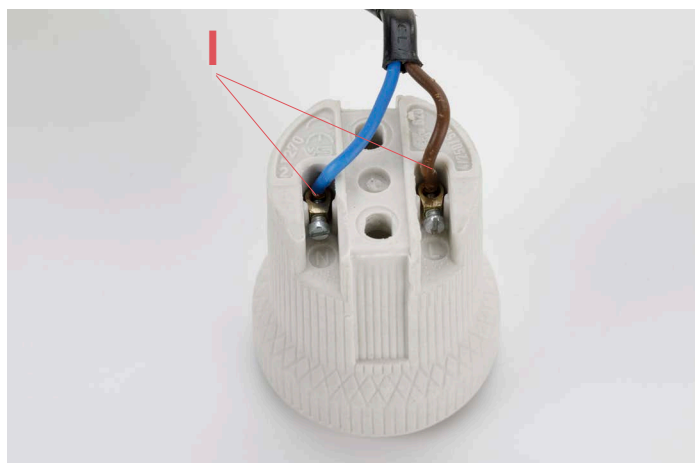

Fig.8

Fasten the lamp holder fixing screws (G).(Fig.6 page 12)

Clamp the cable by fastening the screws (F) of the cable clamp.(Fig.5 page 12)

Assemble the protection cover by fastening the two lateral screws (E).(Fig.4 page 12)

Collocate the diffuser (D) on the diffuser support (A).(Fig.2 page 10)

Insert the lamp-bulb. (Fig.1 page 9)

WARNING! When installing and whenever acting on the appliance, ensure that the power supply has been switched off. For the installation of the spare-part, it is necessary to consult a qualified electrician.

RAY F1 F5916030

EN

RF5912100

KIT OF QUANTITY 4 ADJUSTABLE FEET



Ray F1
p.15



Ray F2
p.15

WARNING! When installing and whenever acting on the appliance, ensure that the power supply has been switched off.
For the installation of the spare-part, it is necessary to consult a qualified electrician.

RAY F1 F5916030

EN

RF5912100

KIT OF QUANTITY 4 ADJUSTABLE FEET

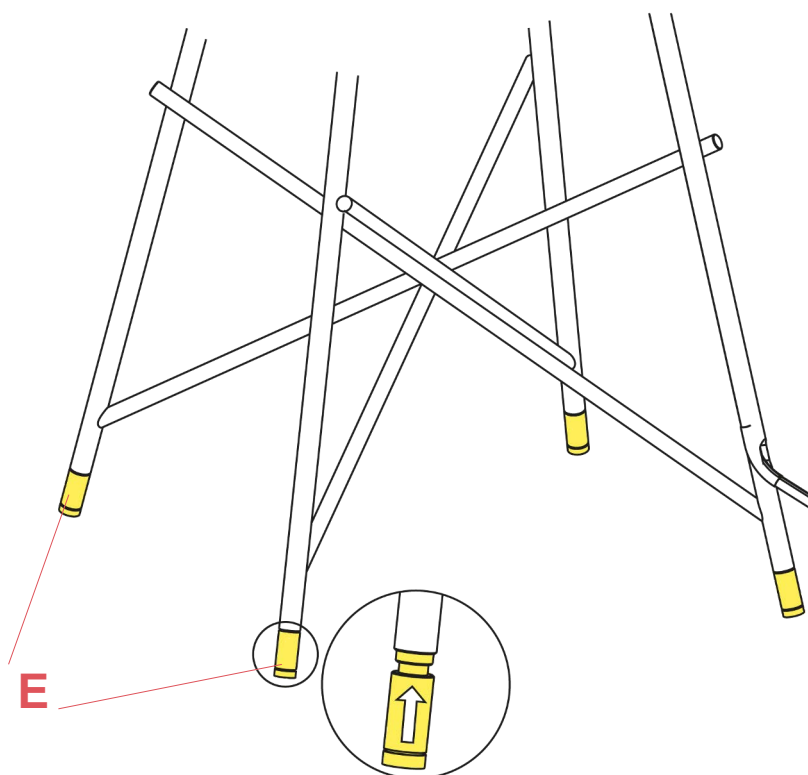

Fig.1

Screw the adjustable feet (E) to the lamp legs.

WARNING! When installing and whenever acting on the appliance, ensure that the power supply has been switched off.
For the installation of the spare-part, it is necessary to consult a qualified electrician.

RAY F1 F5916030

EN

RF28045

LED 220/240V 40-250W 4-100W RONDÒ DIMMER



Bibliothèque
Nationale
p.05



Glo-ball
F1
p.05



Glo-ball
F2
p.05



Glo-ball
F3
p.05



Ic F1
p.05



Ic F2
p.05



Ktribe
F2
p.05



Ktribe
F3
p.05



Lounge
Gun
p.13



Luminator
Dim
p.05



Parentesi D
p.32



Ray
F1
p.17



Ray F2
p.17



Romeo
Moon F
p.44



Romeo
Soft
p.33



Spun
Light F
p.09



Toio
Led
p.38

WARNING! When installing and whenever acting on the appliance, ensure that the power supply has been switched off.
For the installation of the spare-part, it is necessary to consult a qualified electrician.

RAY F1 F5916030

EN

RF28045

LED 220/240V 40-250W 4-100W RONDÒ DIMMER



Fig.1



Fig.2

Open the box of the damaged dimmer.

For the opening, it is necessary to remove the rubber pad from underneath the dimmer box;

Unfasten the screw that locks the triangle terminal cover;

WARNING! When installing and whenever acting on the appliance, ensure that the power supply has been switched off.
For the installation of the spare-part, it is necessary to consult a qualified electrician.

©2021 Flos - All rights reserved - www.flos.com
Flos reserves the right to introduce any changes to its own models, without prior notice.

RAY F1 F5916030

EN

RF28045

LED 220/240V 40-250W 4-100W RONDÒ DIMMER

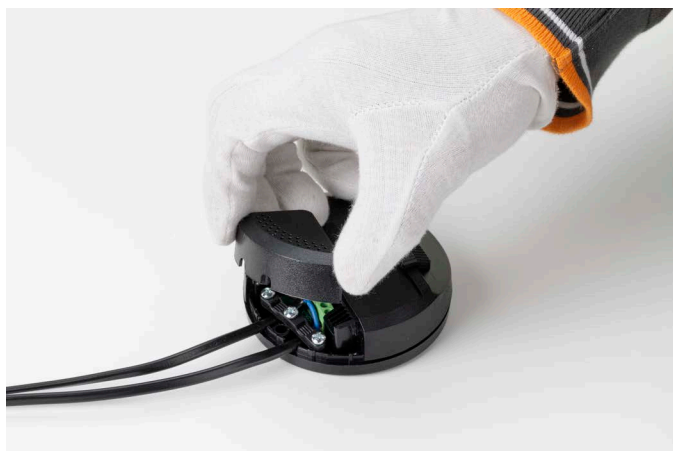

Fig.3

Turn the dimmer box and remove the terminal cover;

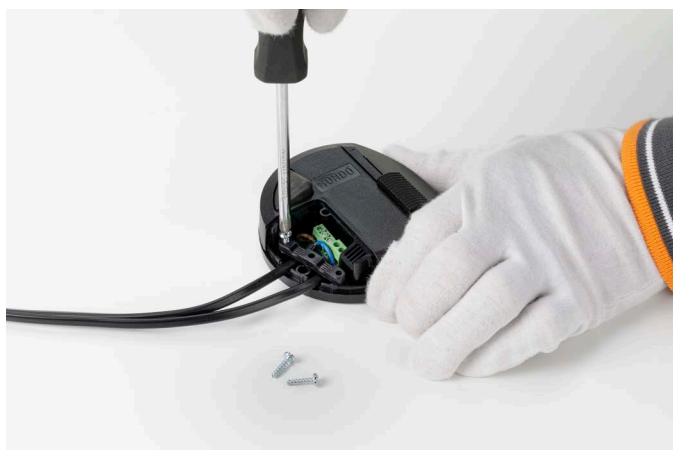

Fig.4

Unfasten the three screws of the cable clamps;

WARNING! When installing and whenever acting on the appliance, ensure that the power supply has been switched off. For the installation of the spare-part, it is necessary to consult a qualified electrician.

©2021 Flos - All rights reserved - www.flos.com
Flos reserves the right to introduce any changes to its own models, without prior notice.

RAY F1 F5916030

EN

RF28045

LED 220/240V 40-250W 4-100W RONDÒ DIMMER



Fig.5

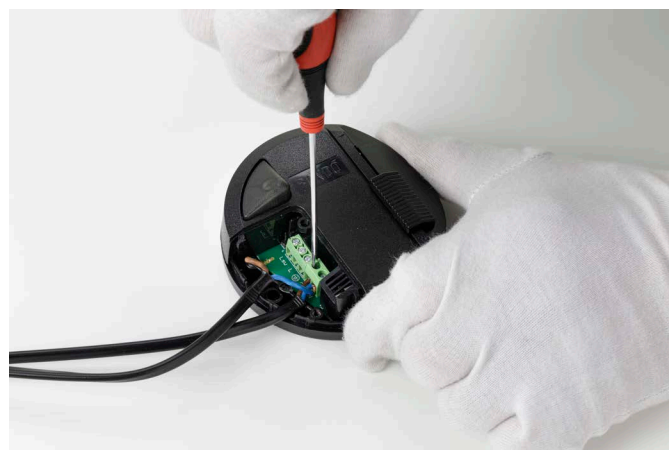

Fig.6

Remove the cable clamp (refer to fig. 5) and disconnect the cables from the green terminal box.

Assemble now the new dimmer:

Connect the cables respecting the polarities, lock the wires by positioning the cable clamp and then fasten the three screws, cover the green terminal box with the triangle cover, turn the dimmer box, fasten the screw and stick-on the rubber pads.

WARNING! When installing and whenever acting on the appliance, ensure that the power supply has been switched off.
For the installation of the spare-part, it is necessary to consult a qualified electrician.

©2021 Flos - All rights reserved - www.flos.com
Flos reserves the right to introduce any changes to its own models, without prior notice.