

BLU
DOT

MODULAR AND STYLISH,
WHO KNEW?

MODU- LICIOUS

Queen / Full Bed

ASSEMBLY INSTRUCTIONS

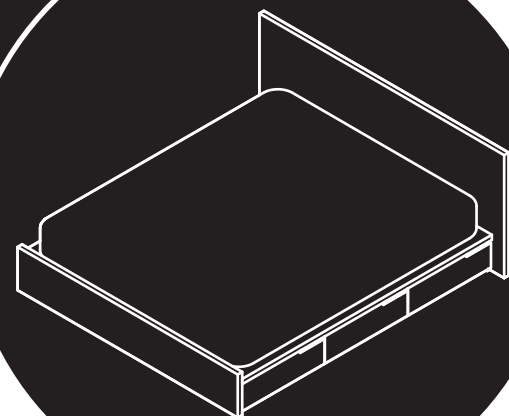
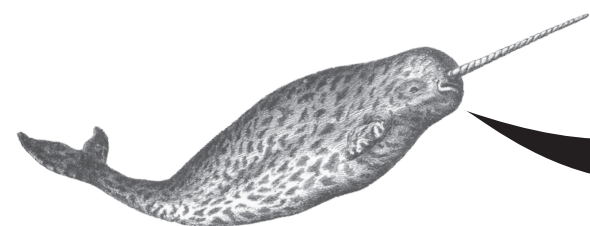

CARE

Clean with a slightly damp, soft cloth. To remove dirt and fingerprints, use a quality cleaner formulated for wood furniture. Wipe completely dry with a soft cloth in the direction of the wood grain.

Clean powder-coated units with a soft cloth or sponge using a mild detergent, such as dish soap, and warm water. Wipe completely dry with a soft cloth.

HARDWARE

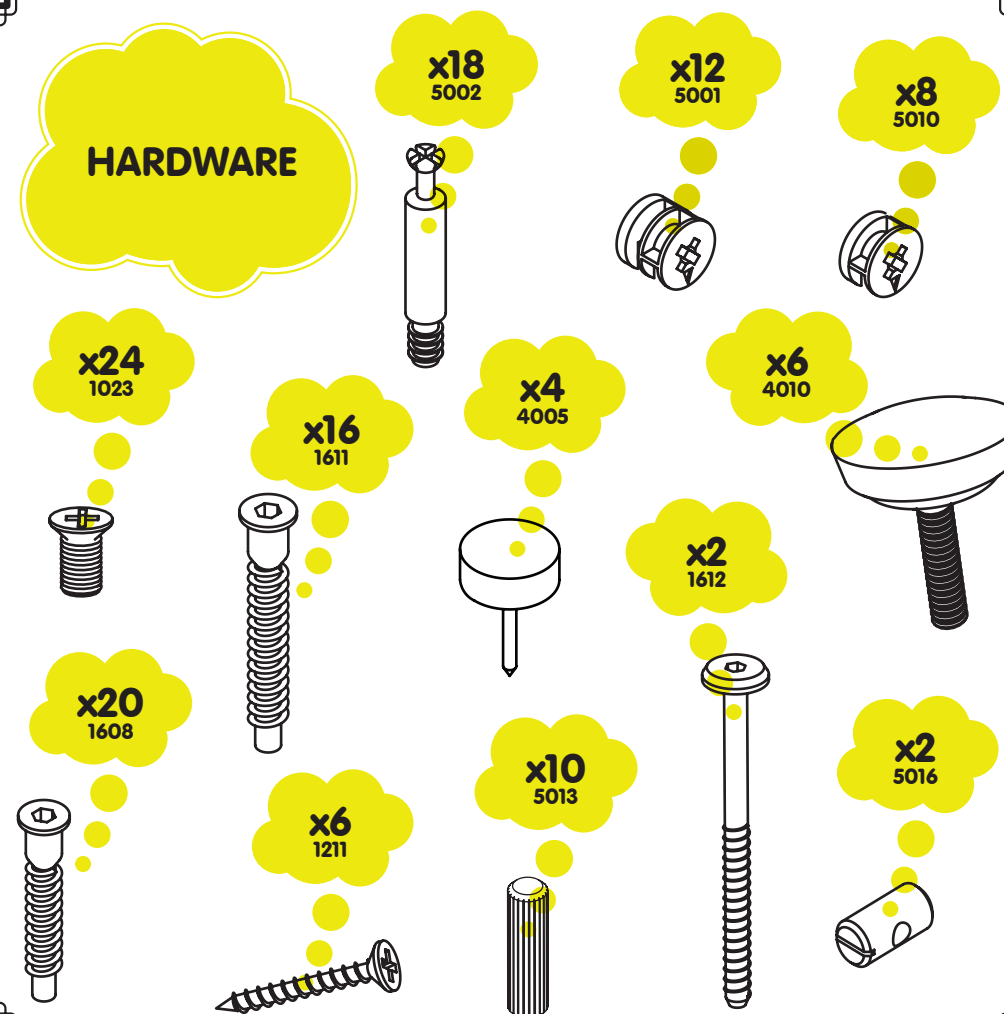

PARTS LIST

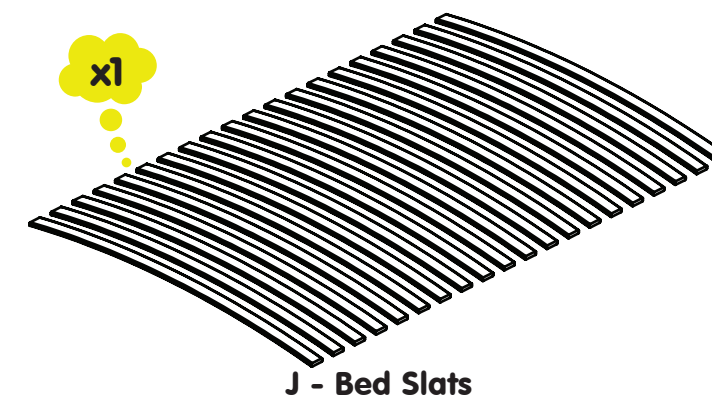
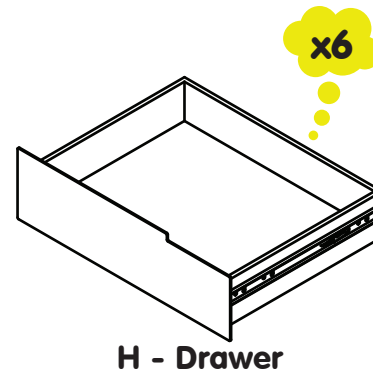
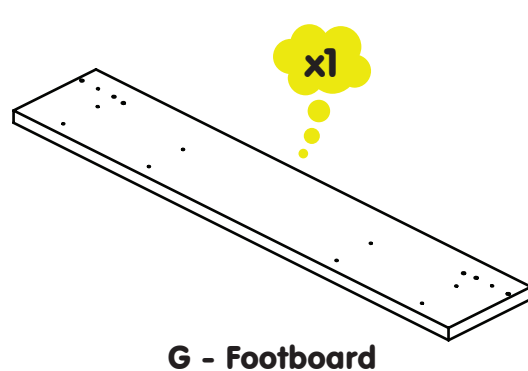
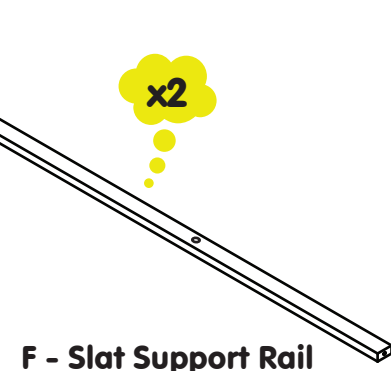
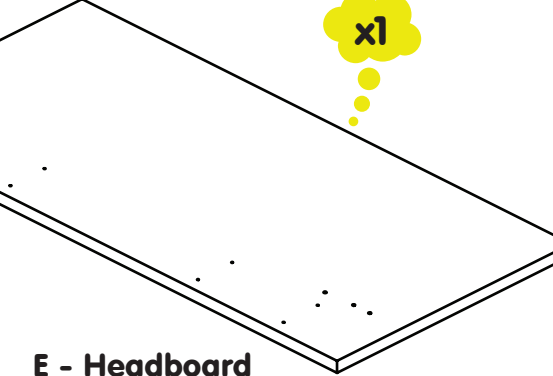
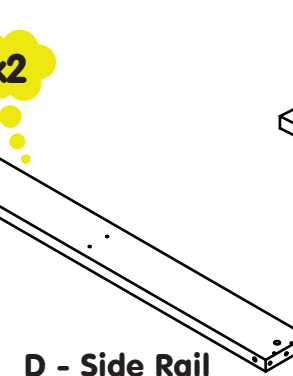
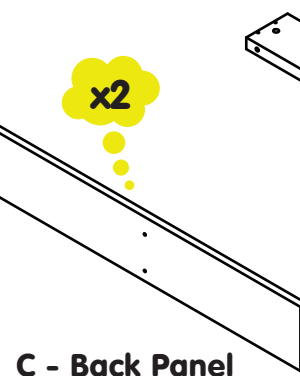
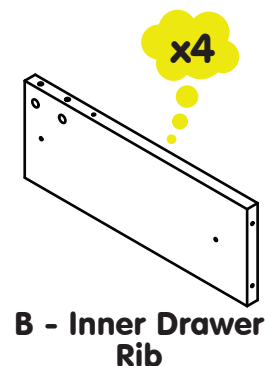
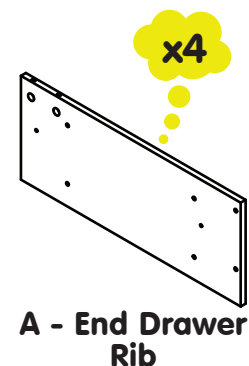

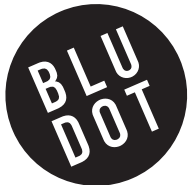

HOW TO USE CAM LOCK HARDWARE



1

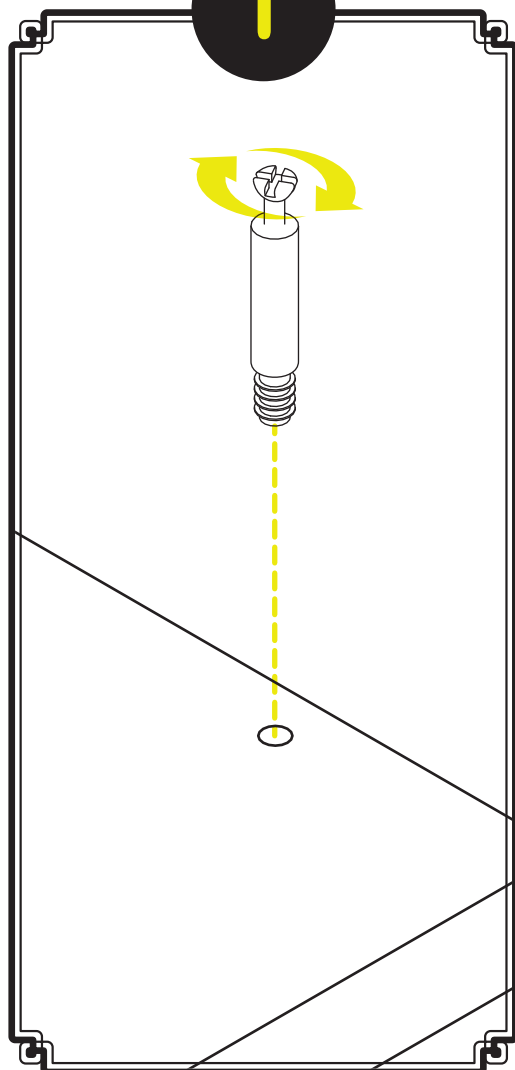

2

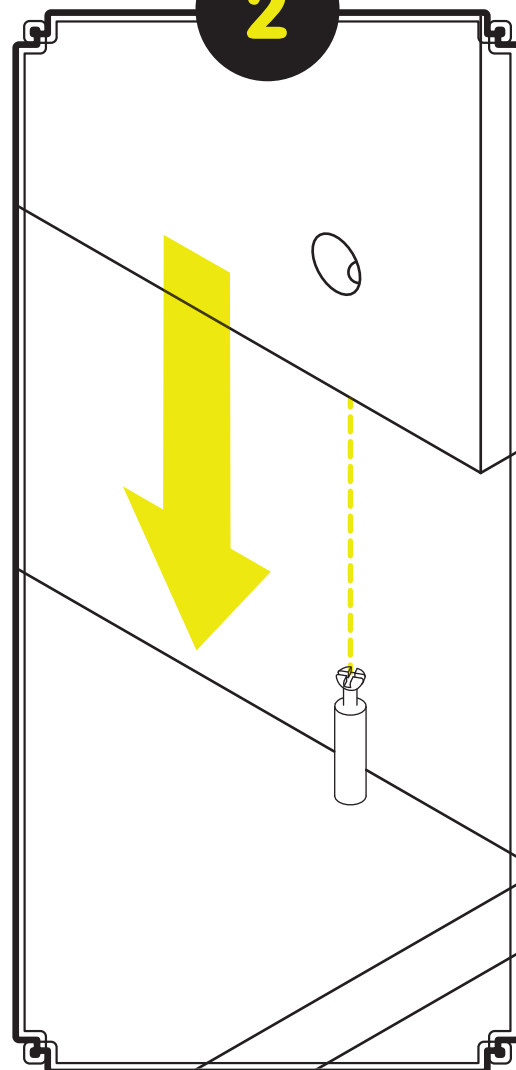

3

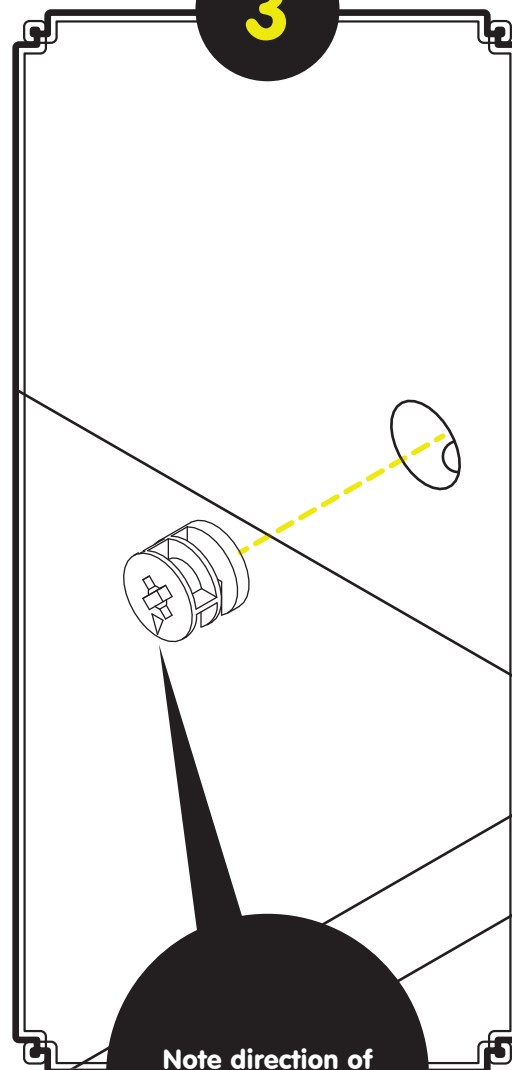

4

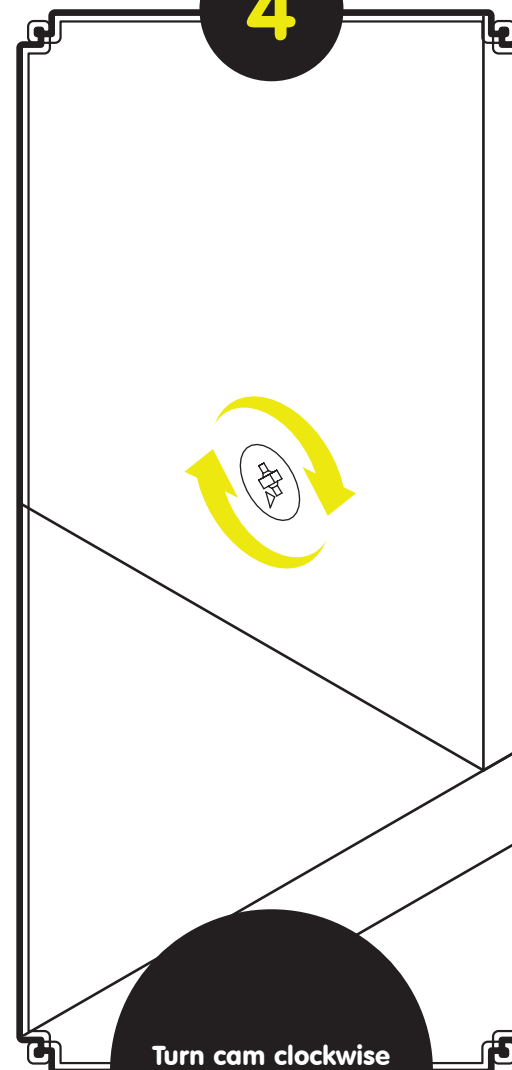

5

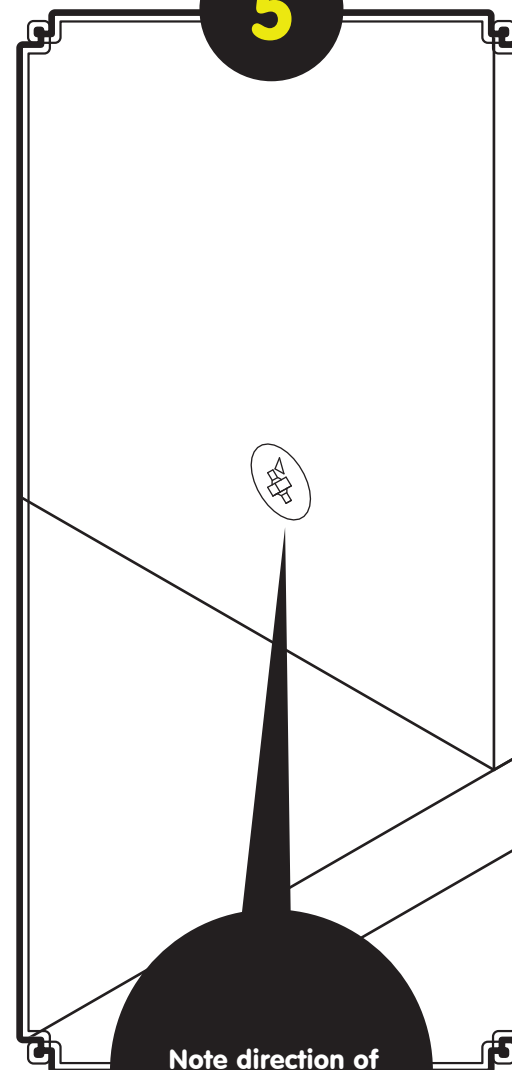

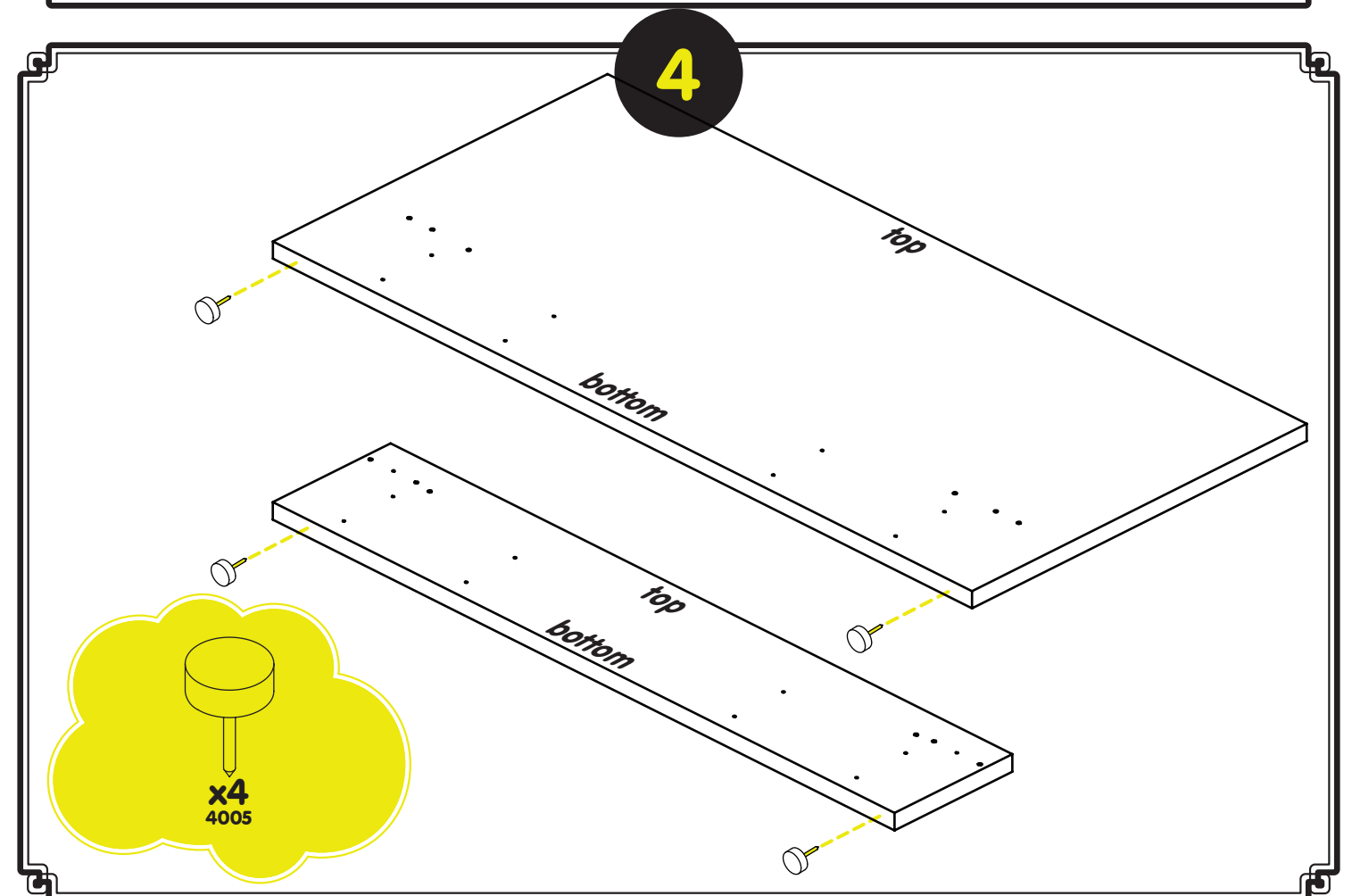
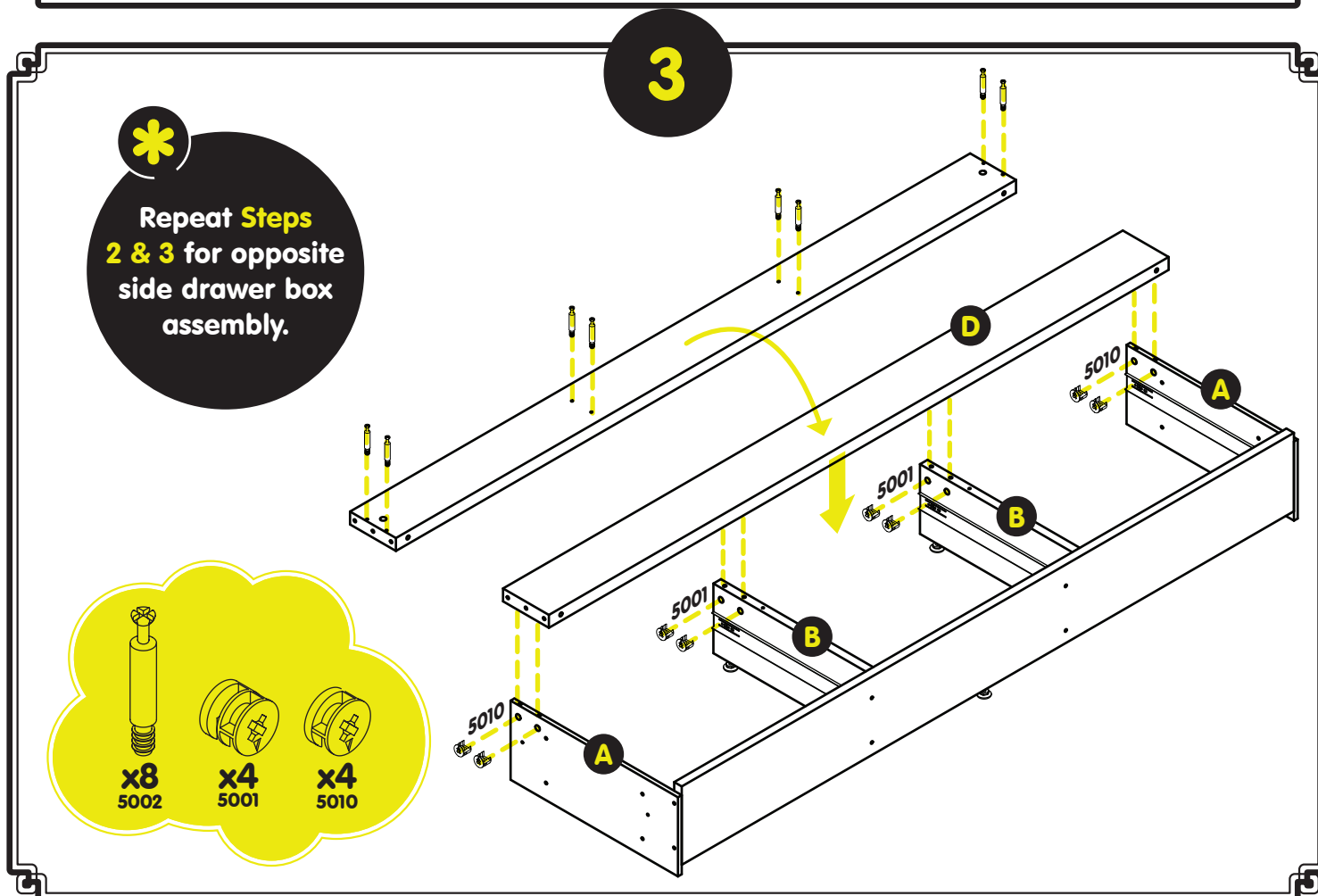
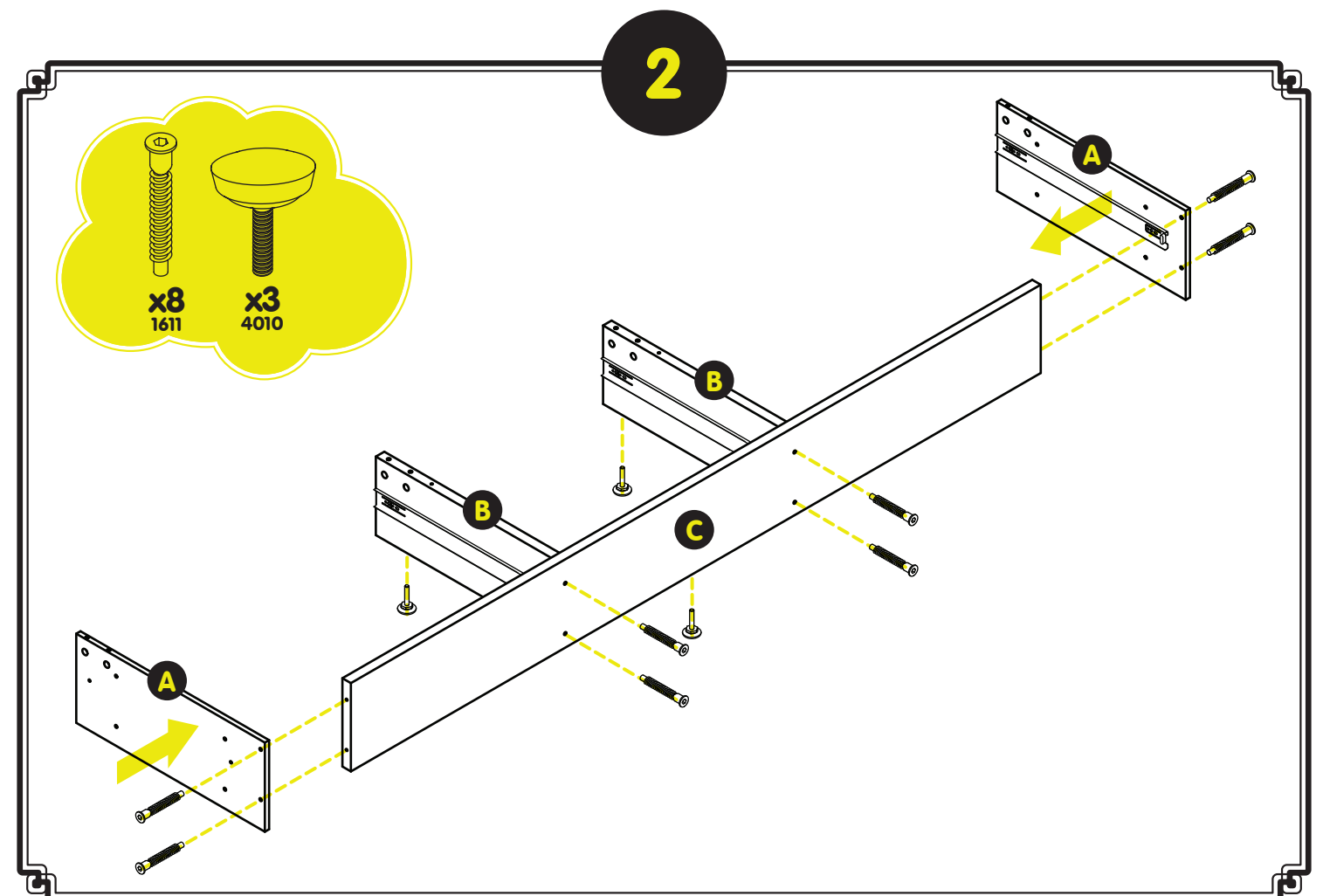
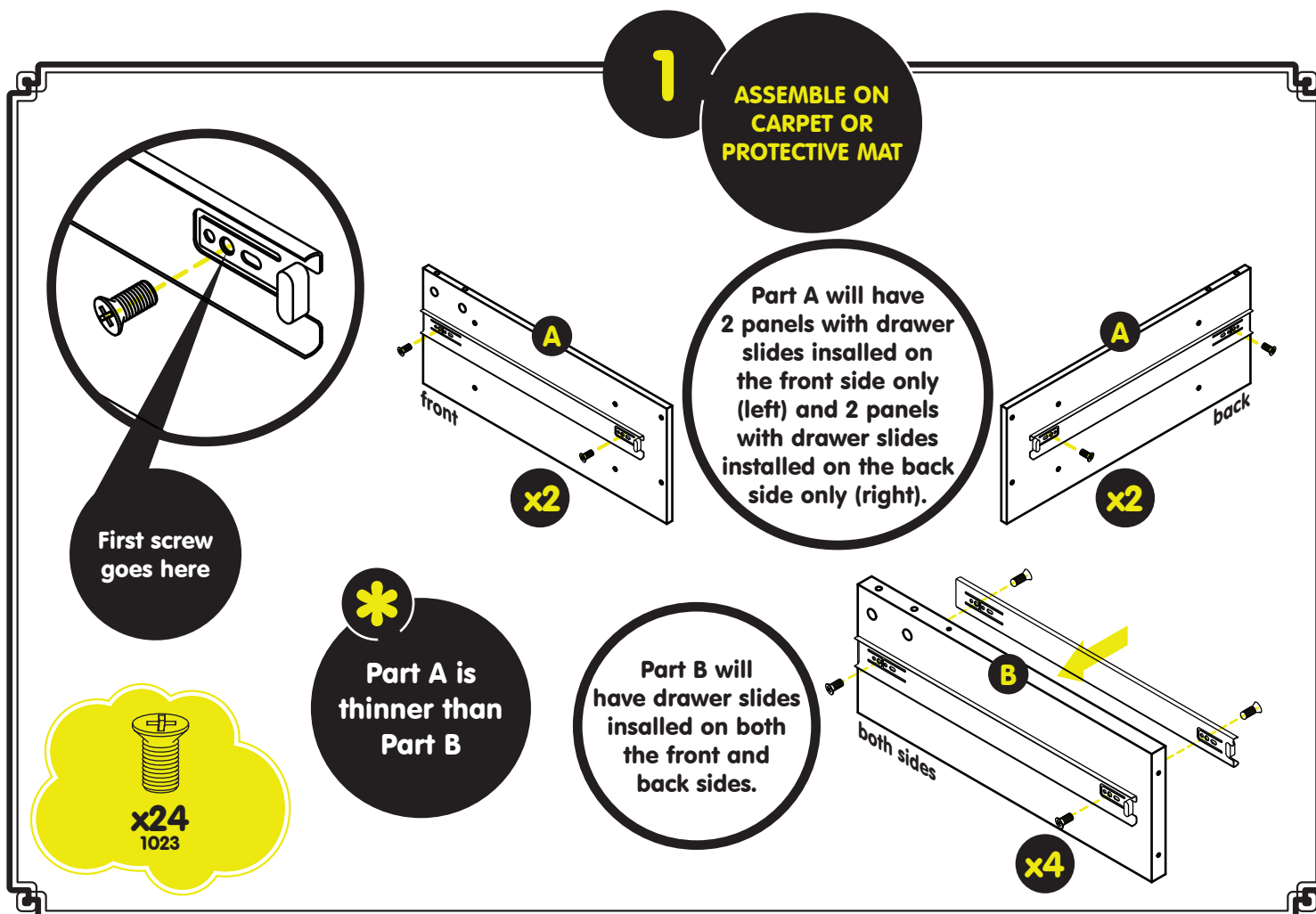

5

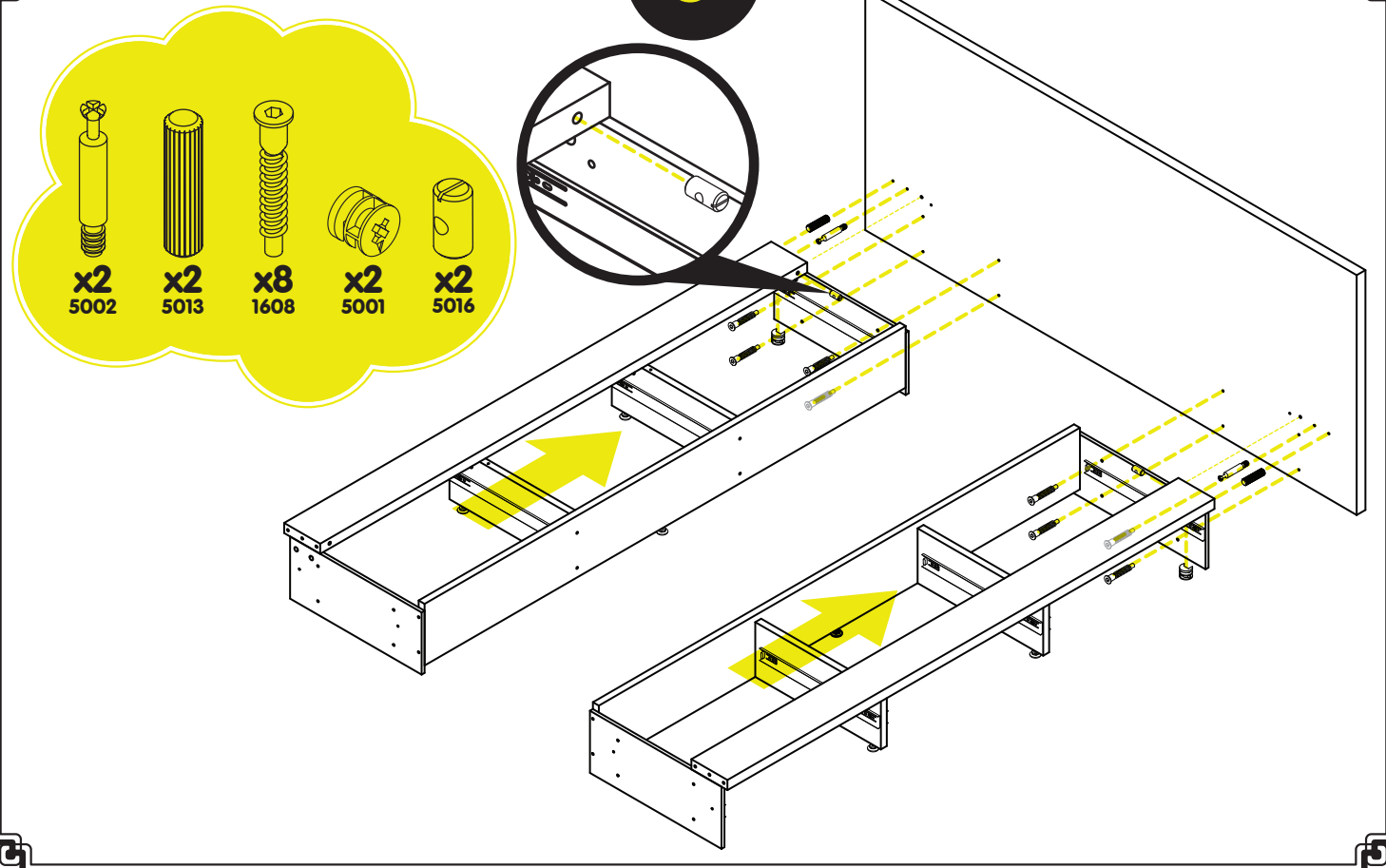

6

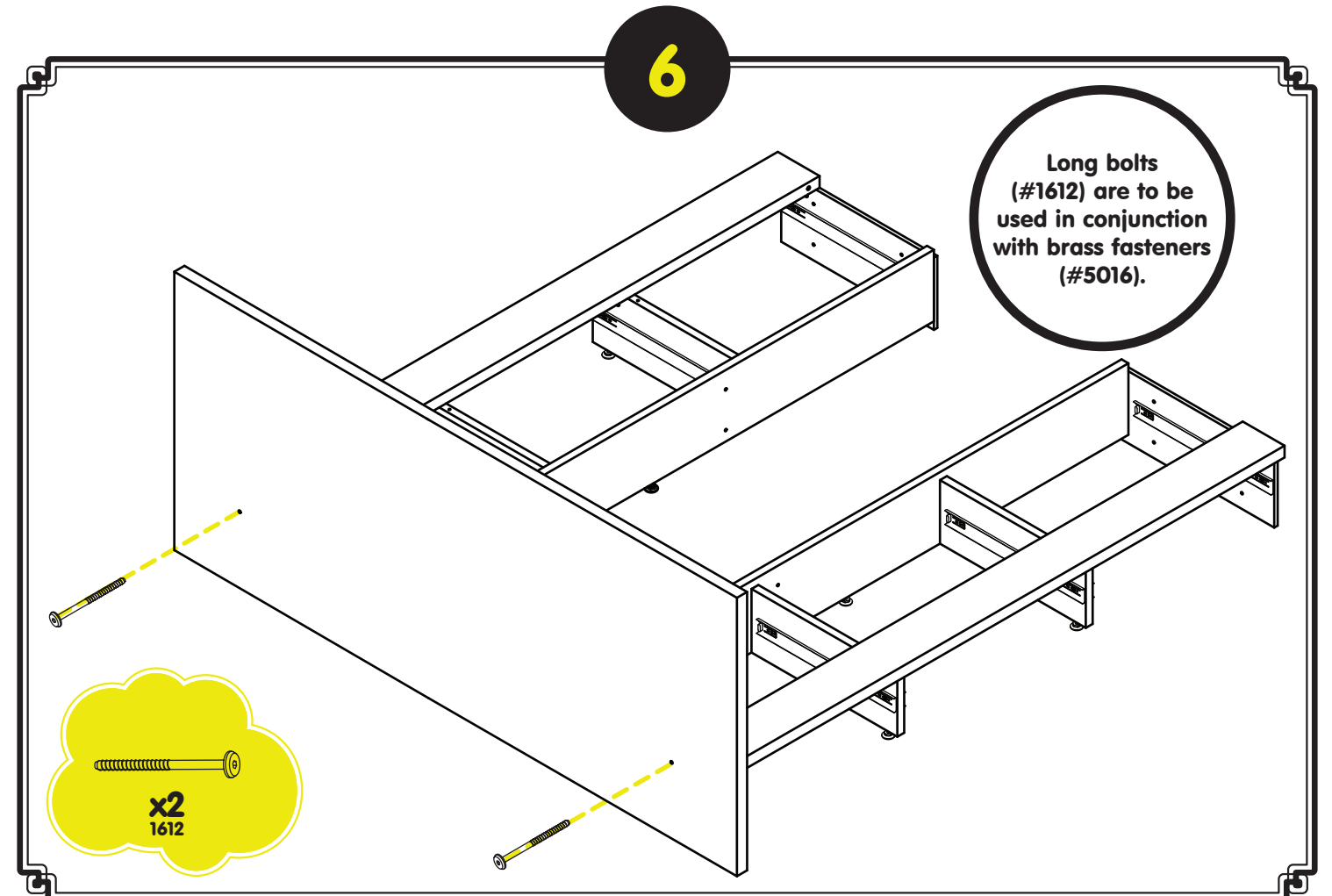

7

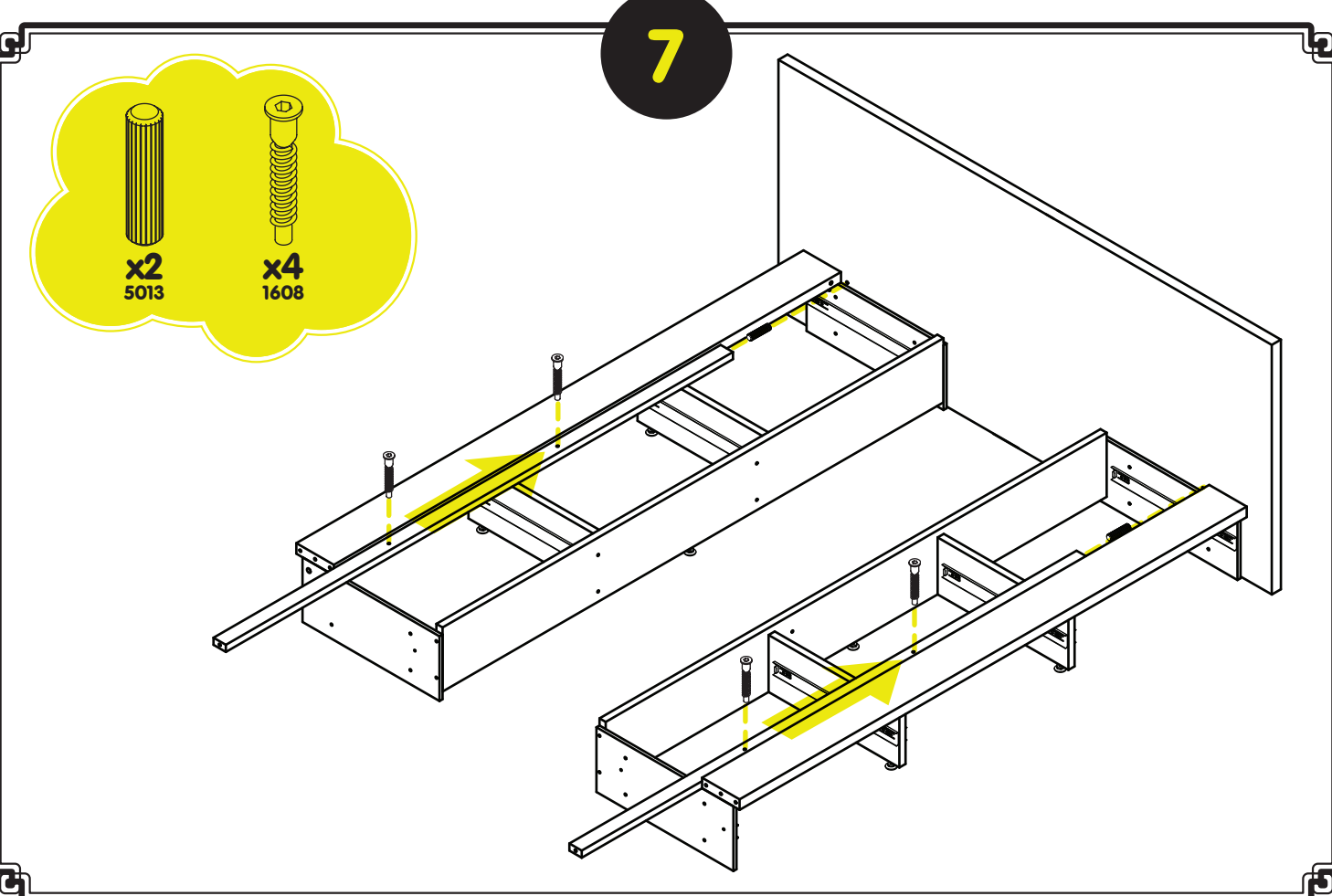

8

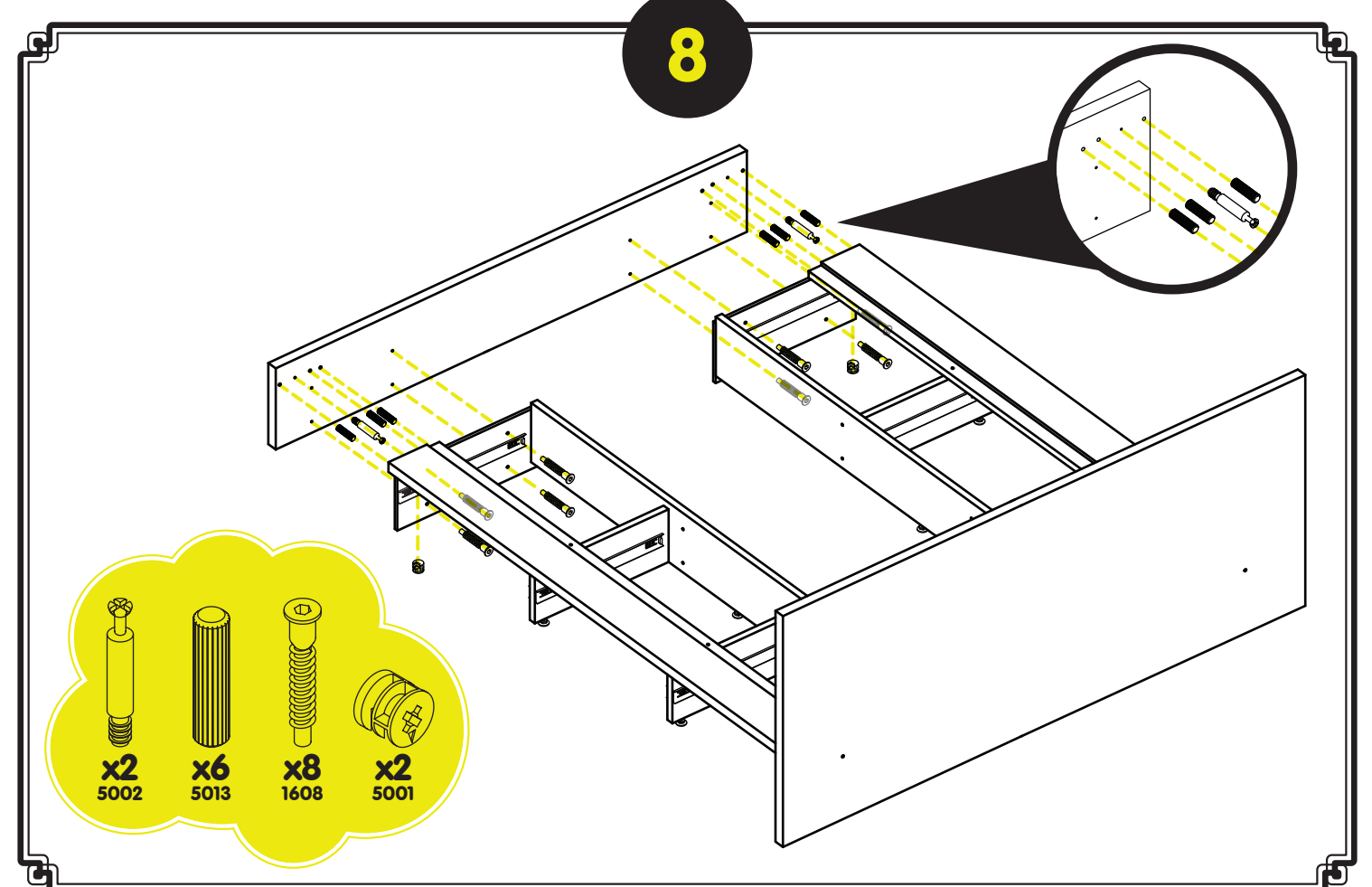

9

x6
1211

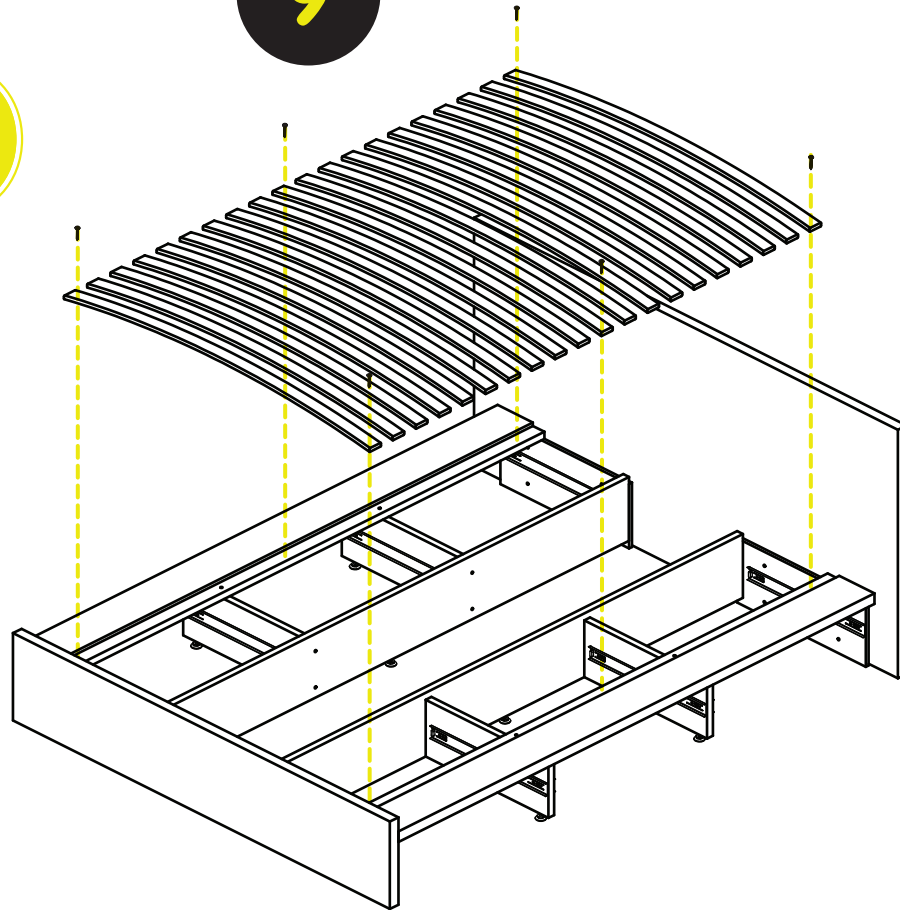

10

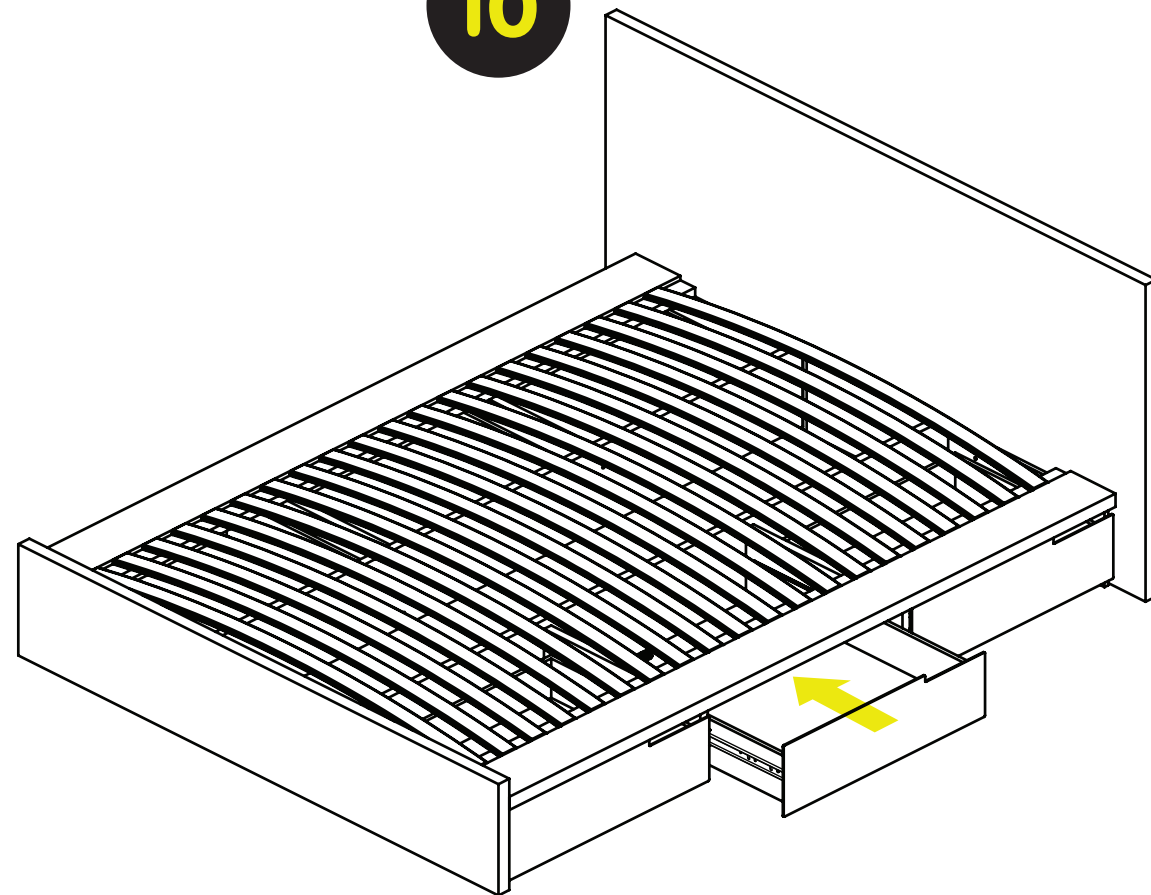

NOTES

To remove drawers pull lever up on the right side and push down on the left side of the ball bearing drawer slide.

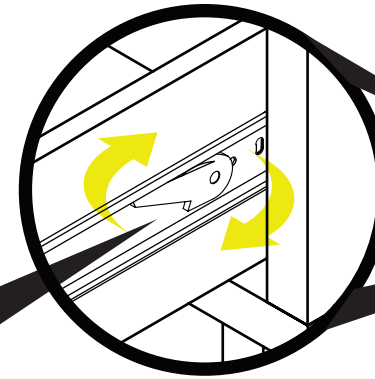

Drawer fronts can be adjusted if drawer gaps are inconsistent.

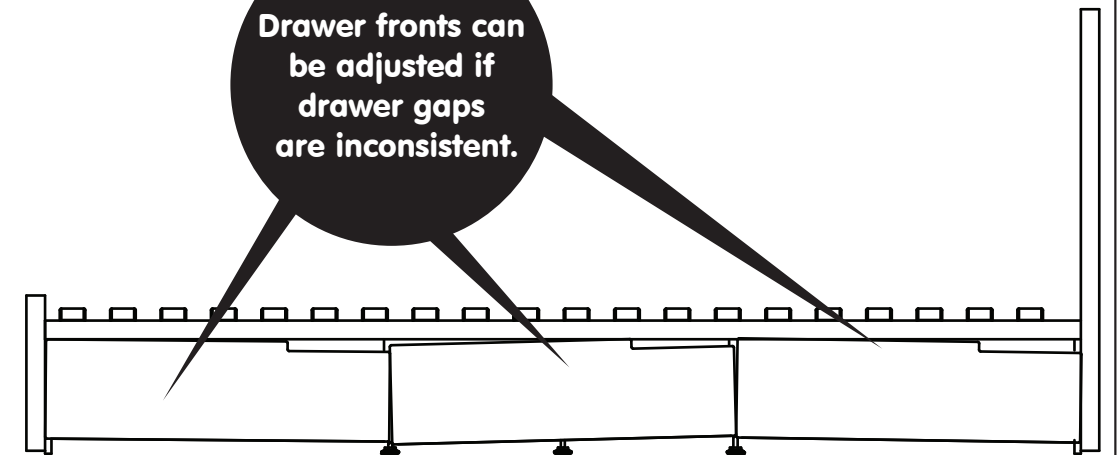

Loosen the acorn nuts, shift the drawer front into place and ask a friend to hold the drawer front in place while you re-tighten the nuts (but don't over tighten)

