

KELVIN LED F

Designed by Antonio Citterio, 2009

F3305033

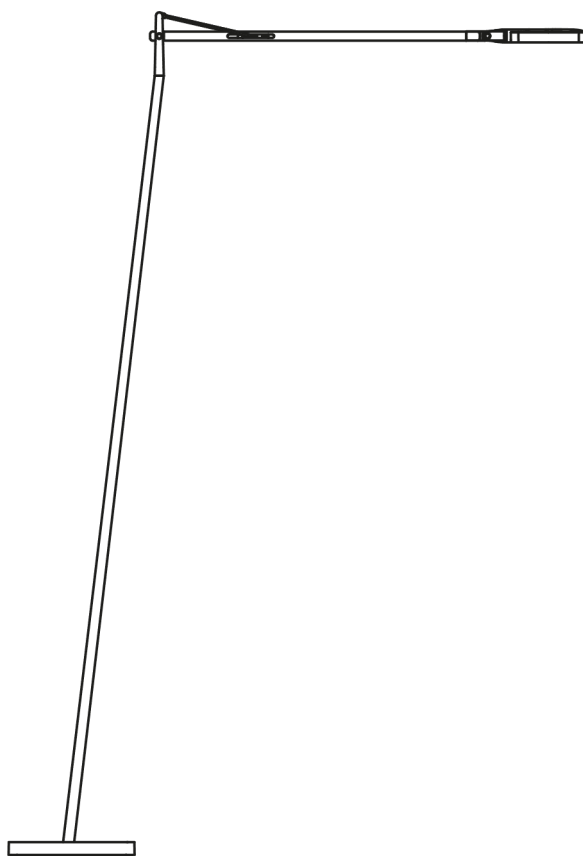

KELVIN LED F

F3305033

EN

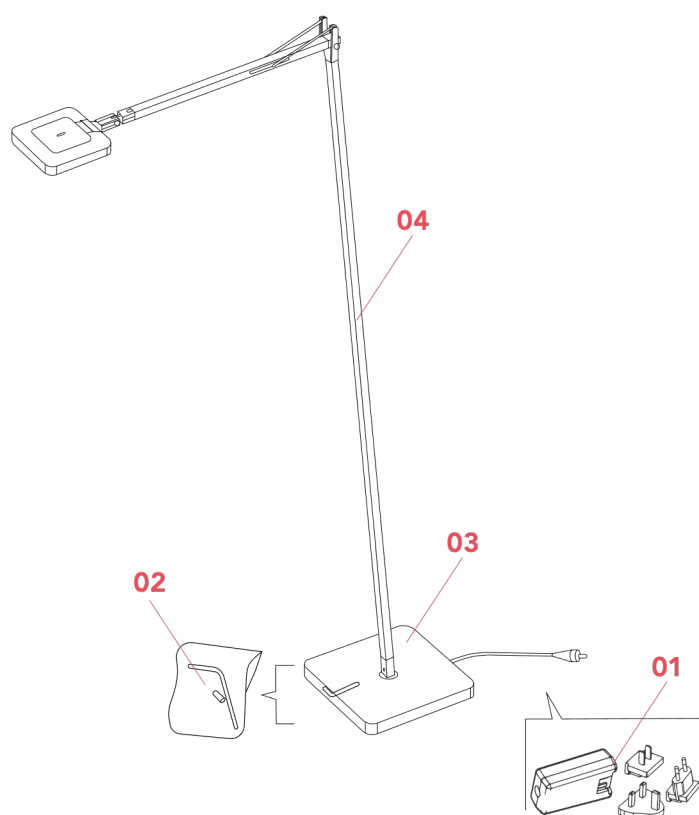

- 01. RF3320100** – Black Plug kit & driver
- 02. RF3320300** – Kit with screw and allen keys
- 03. F3322033A** – Kelvin Led anthracite base
- 04. F3306033B** – Kelvin Led anthracite body

KELVIN LED F F3305033

EN

RF3320100

BLACK PLUG KIT & DRIVER



Copycat
p.05



Goldman
p.03



Kelvin
Edge
p.03



Kelvin
Led F
p.03



Kelvin
Led GM
p.03



Ok
p.38



Serena
p.10



Tab F
p.03



Tab T
p.03



Taccia
Small Led
p.11

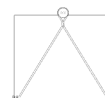

To-Tie
All
Versions
p.03



Wirering
p.20

WARNING! When installing and whenever acting on the appliance, ensure that the power supply has been switched off. For the installation of the spare-part, it is necessary to consult a qualified electrician.

KELVIN LED F F3305033

EN

RF3320100

BLACK PLUG KIT & DRIVER

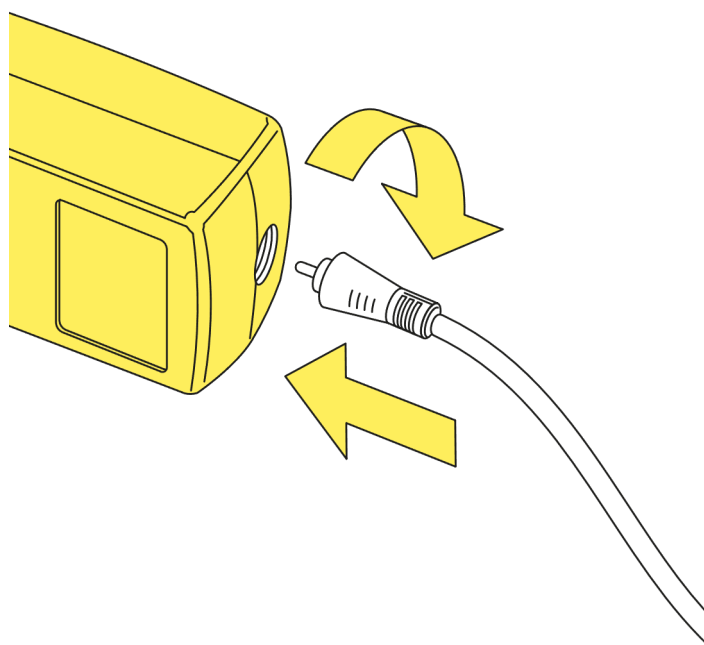

Fig.1

Insert the plug into the driver unit by using the guides snap it inside its apposite slot (use the correct type of plug for the area in which the device must be installed), connect the plug to the feeder unit locking it in by rotating it 90° clockwise.

WARNING! When installing and whenever acting on the appliance, ensure that the power supply has been switched off.
For the installation of the spare-part, it is necessary to consult a qualified electrician.

KELVIN LED F F3305033

EN

RF3320300

KIT WITH SCREW AND ALLEN KEYS

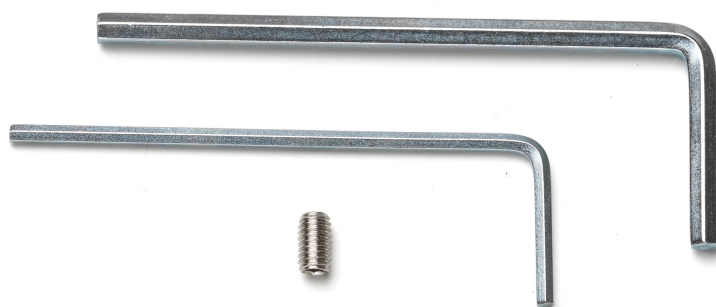

WARNING! When installing and whenever acting on the appliance, ensure that the power supply has been switched off.
For the installation of the spare-part, it is necessary to consult a qualified electrician.

©2021 Flos - All rights reserved - www.flos.com
Flos reserves the right to introduce any changes to its own models, without prior notice.

KELVIN LED F F3305033

EN

RF3320300

KIT WITH SCREW AND ALLEN KEYS

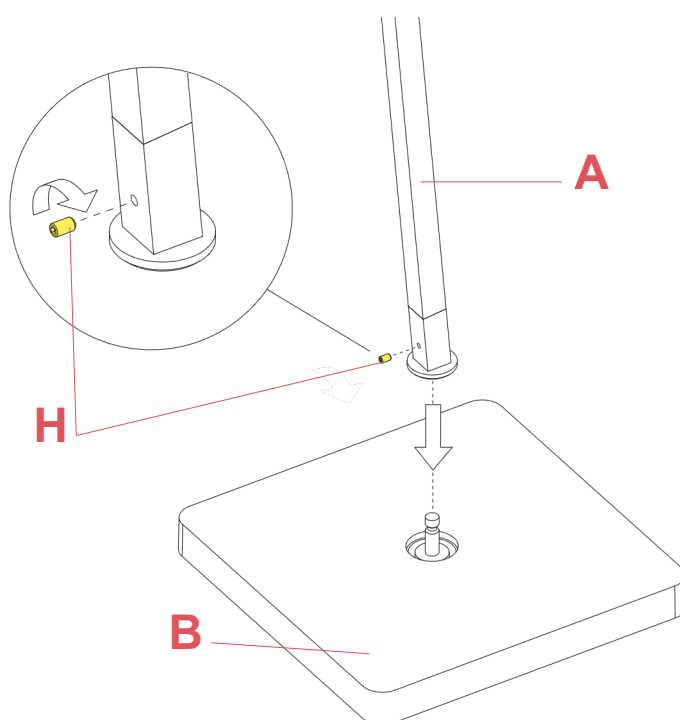

Fig.1

Insert the device support (A) into the pin (B) of the base and fasten the safety pin screw (H) through Allen key hex 1,5mm.

WARNING! When installing and whenever acting on the appliance, ensure that the power supply has been switched off. For the installation of the spare-part, it is necessary to consult a qualified electrician.

©2021 Flos - All rights reserved - www.flos.com
Flos reserves the right to introduce any changes to its own models, without prior notice.

KELVIN LED F F3305033

EN

RF3320300

KIT WITH SCREW AND ALLEN KEYS

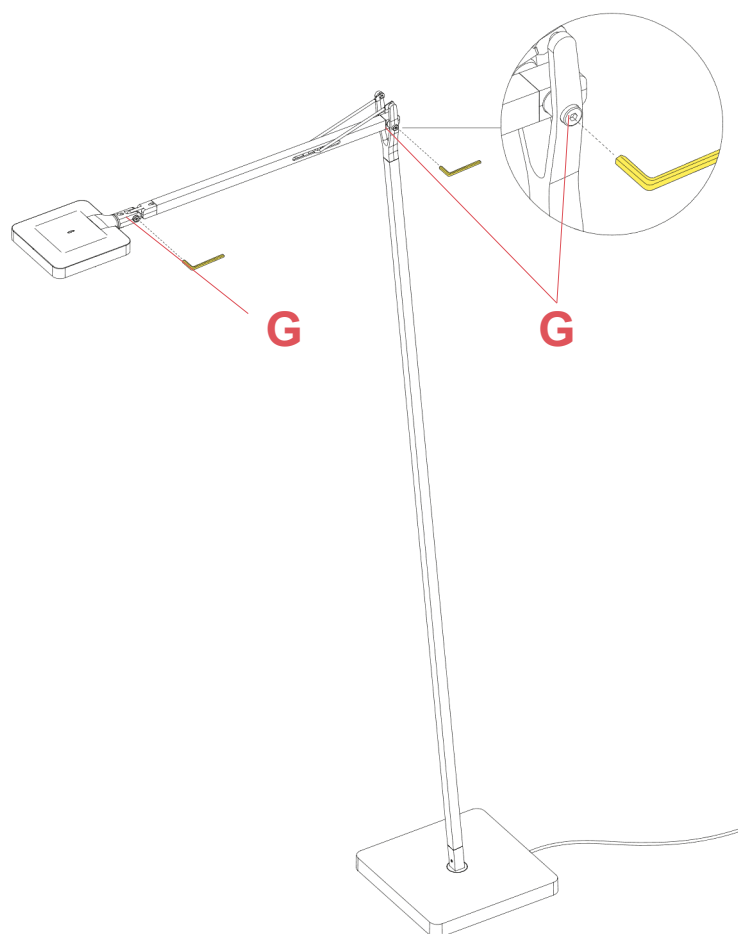

Fig.2

To adjust the balancing and structure of the device it is necessary to tighten or loosen the screws (G) with the Allen key hex 3mm supplied with the spare-part packet.

WARNING! When installing and whenever acting on the appliance, ensure that the power supply has been switched off. For the installation of the spare-part, it is necessary to consult a qualified electrician.

©2021 Flos - All rights reserved - www.flos.com
Flos reserves the right to introduce any changes to its own models, without prior notice.

KELVIN LED F F3305033

EN

F3322033A

KELVIN LED F ANTHRACITE BASE



WARNING! When installing and whenever acting on the appliance, ensure that the power supply has been switched off.
For the installation of the spare-part, it is necessary to consult a qualified electrician.

©2021 Flos - All rights reserved - www.flos.com
Flos reserves the right to introduce any changes to its own models, without prior notice.

KELVIN LED F F3305033

EN

F3322033A

KELVIN LED F ANTHRACITE BASE

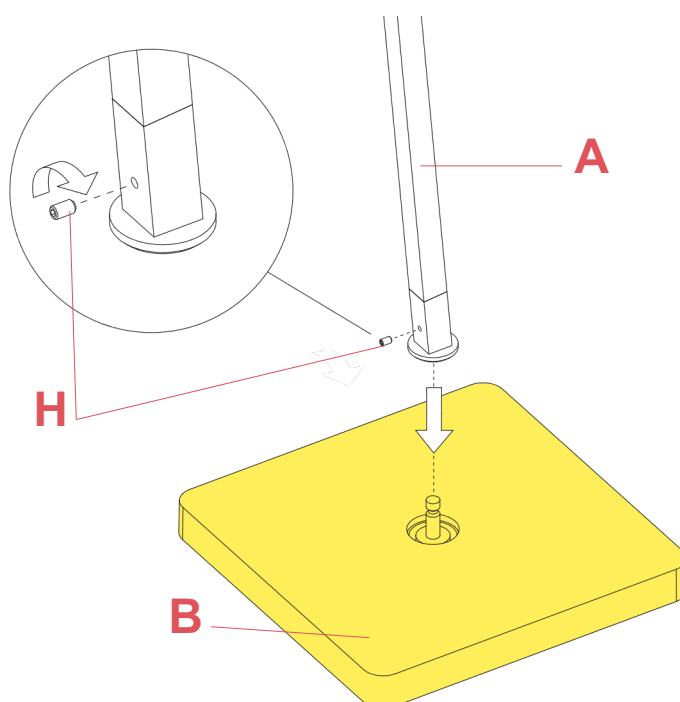

Fig.1

Insert the device support (A) into the pin (B) of the base and fasten the safety pin screw (H) by utilizing an Allen key hex 1,5mm.

REMARK! Be careful whilst tightening the safety pin screw to not scratch the base of the device.

WARNING! When installing and whenever acting on the appliance, ensure that the power supply has been switched off.
For the installation of the spare-part, it is necessary to consult a qualified electrician.

©2021 Flos - All rights reserved - www.flos.com
Flos reserves the right to introduce any changes to its own models, without prior notice.

KELVIN LED F F3305033

EN

F3306033B

KELVIN LED F ANTHRACITE BODY



WARNING! When installing and whenever acting on the appliance, ensure that the power supply has been switched off.
For the installation of the spare-part, it is necessary to consult a qualified electrician.

©2021 Flos - All rights reserved - www.flos.com

Flos reserves the right to introduce any changes to its own models, without prior notice.

KELVIN LED F F3305033

EN

F3306033B

KELVIN LED F ANTHRACITE BODY

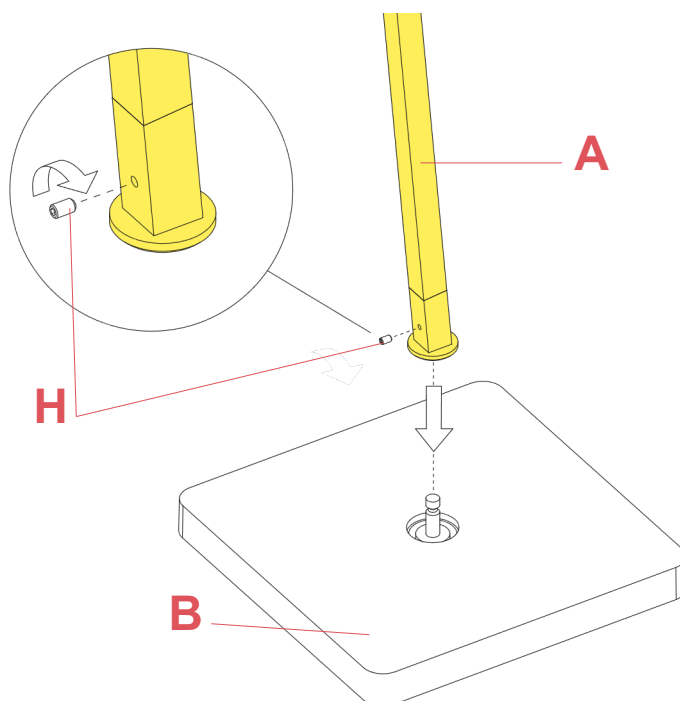

Fig.1

Insert the device support (A) into the pin (B) of the base and fasten the safety pin screw (H) by utilizing an Allen key hex 1,5mm.

REMARK! Be careful whilst tightening the safety pin screw to not scratch the base of the device.

WARNING! When installing and whenever acting on the appliance, ensure that the power supply has been switched off.
For the installation of the spare-part, it is necessary to consult a qualified electrician.

©2021 Flos - All rights reserved - www.flos.com
Flos reserves the right to introduce any changes to its own models, without prior notice.