

# FLOS

F3305033 Anthracite

## Kelvin Led Floor

Designed by Antonio Citterio/assistant Toan Nguyen, Antonio Citterio, 2011

8W - 285lm - 2700K

Part of the popular Kelvin LED family, the Kelvin LED F floor lamp features the collection's signature square head and utilizes the latest technology to provide precise customization of output. The three-step on/off switch utilizes Soft Touch technology, and the base cover is injection-printed PC (polycarbonate). The head is directional, the counterweight is an iron cut painted through a process of cataphoresis. The base separates from the lamp body, held in place with a safety-locking pin. Inspiration behind the design: Inspired by a love of industrial design, creators Antonio Citterio and Toan Nguyen developed the Kelvin family to blend seemingly simple structures with the most innovative technologies and materials.

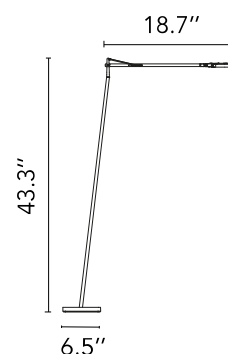

Are you a professional and your project needs consulting and support?

BOOK AN APPOINTMENT

### Main specifications

Mounting	Floor
Environments	Indoor dry location
Light Source Type	LED
Light sources included	Yes
LED type	LED Module
Power (W)	8
System flux (lm)	285

### Physical

Color	Anthracite
Length (in)	26.58
Cord color	Black
Cord length (in)	59.055
Net weight (lb)	8.38
Package volume (in)	2281.01
IP internal	20

### Download

Mounting instructions	PDF
Mounting instructions	PDF

### Photometric Files

LDT / IES	LDT
-----------	-----

### Technical Drawings

2D	ZIP
3D	ZIP

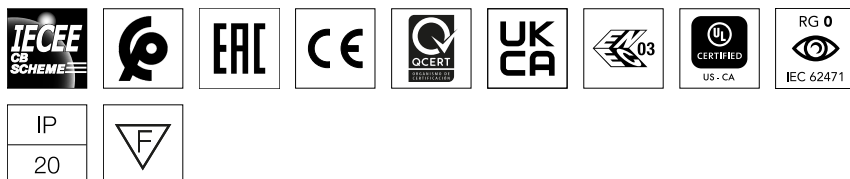

Schematic light drawing

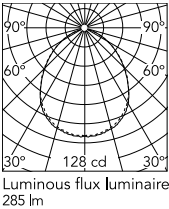

Photometric

Lighting type	Direct
Light distribution	Symmetric
CCT (K)	2700
Extreme cut off	No

Electrical

Insulation class	III
Frequency (Hz)	50/60
Main voltage (Vac)	100-240
Driver	Remote included
Dimmable	Yes
Dimming type	Electronic 24V
Dimming interface	Dimmer Integrated
Plug type	Type G, Type A, Type C
Batteries inside	No

Ecodesign and Energy Labelling

This product contains a light source of energy efficiency class F

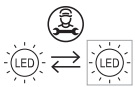

Replaceable (LED only) light source by a professional

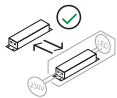

Replaceable control gear by an end-user

Spare Parts

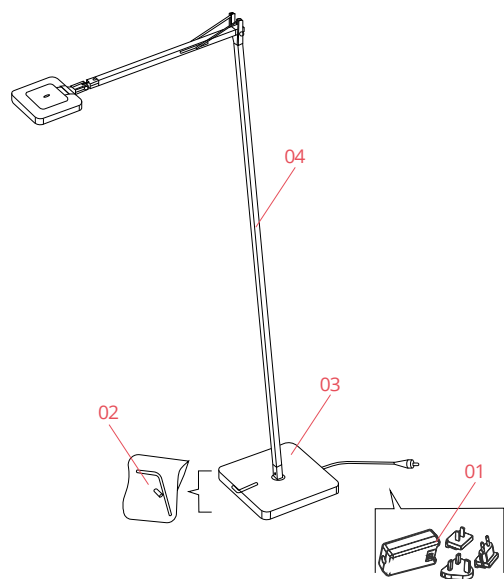

- |     |  |           |
|-----|--|-----------|
| 01. | Black plug assembly kit & 24V driver           | RF3320100 |
| 02. | Kelvin Led Floor Kit with screw and allen keys | RF3320300 |
| 03. | Kelvin led gm anthracite base                  | F3322033A |



RF3320100

Black plug assembly kit & 24V driver



RF3320300

Kelvin Led Floor Kit with screw and allen keys



F3322033A

Kelvin led gm anthracite base